

2008

2008 - 91st Lectureship Summit, "The Righteousness of God", Abilene Christian University

Abilene Christian University

Follow this and additional works at: https://digitalcommons.acu.edu/sumlec_prog

 Part of the [Biblical Studies Commons](#), [Christian Denominations and Sects Commons](#), [Christianity Commons](#), [Comparative Methodologies and Theories Commons](#), [Ethics in Religion Commons](#), [History of Christianity Commons](#), [Liturgy and Worship Commons](#), [Missions and World Christianity Commons](#), [Practical Theology Commons](#), and the [Religious Thought, Theology and Philosophy of Religion Commons](#)

Recommended Citation

Abilene Christian University, "2008 - 91st Lectureship Summit, "The Righteousness of God", Abilene Christian University" (2008). *Lectureship and Summit Programs*. 87.
https://digitalcommons.acu.edu/sumlec_prog/87

This Program is brought to you for free and open access by the Lectureship, Summit, and Ministry Events at Digital Commons @ ACU. It has been accepted for inclusion in Lectureship and Summit Programs by an authorized administrator of Digital Commons @ ACU.

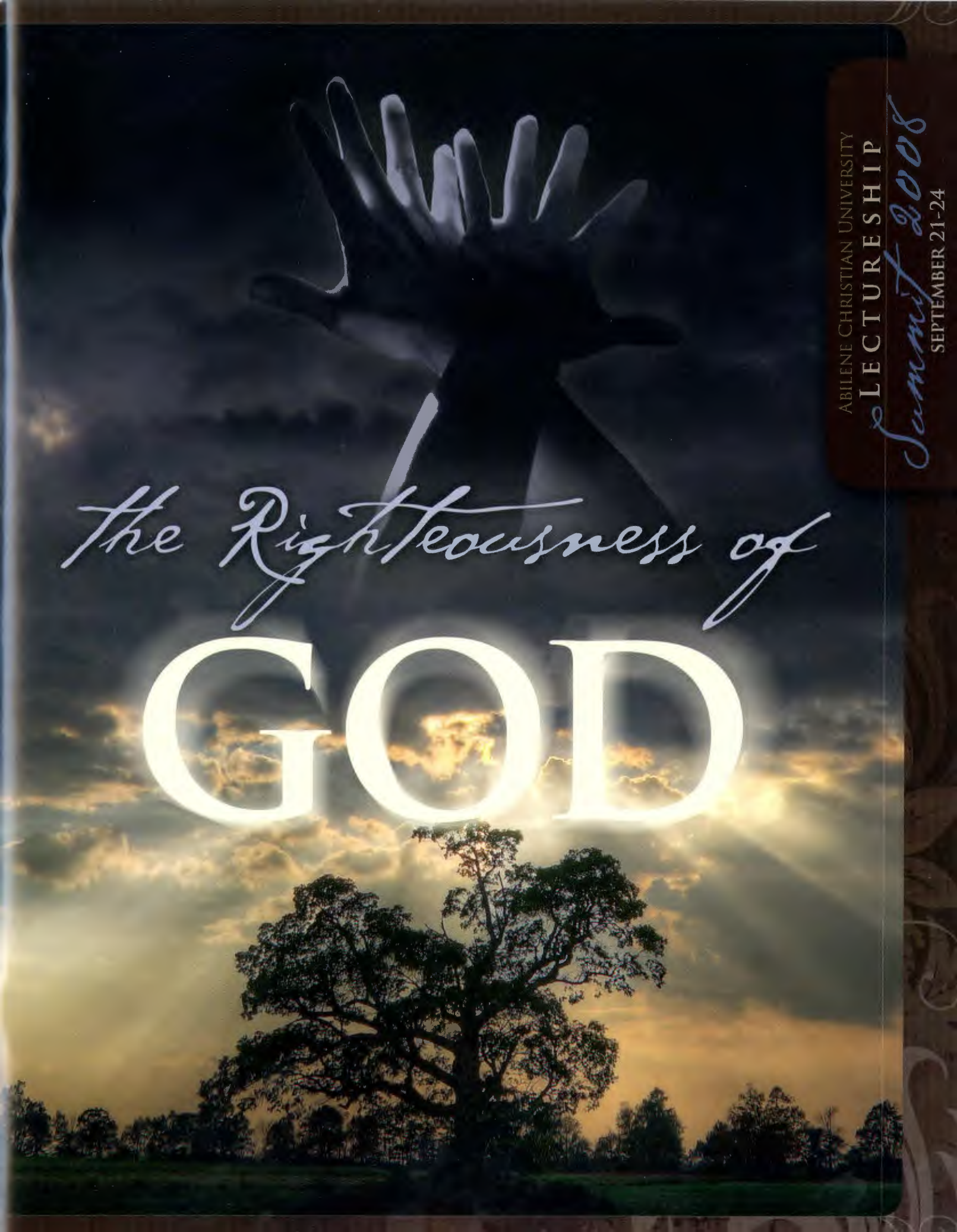

The Righteousness of
GOD

ABILENE CHRISTIAN UNIVERSITY

LECTURESHIP

Summit 2008

SEPTEMBER 21-24



LEROY GARRETT
Sunday 7 p.m.

*Righteousness of God Revealed
through Faith and for Faith*
ROMANS 1:8-17



DAVID FLEER
Monday 11 a.m.

God Shows No Favoritism
ROMANS 2:1-11



KEVIN MURRAY
Monday 7 p.m.

God's Righteousness for Sinners
ROMANS 3:21-26



JAMES THOMPSON
Tuesday 11 a.m.

Sin Condemned in Christ Jesus
ROMANS 8:1-11



RANDY HARRIS
Tuesday 7 p.m.

*From God, Through God and
To God are All Things*
ROMANS 11:25-36



ERIC WILSON
Wednesday 11 a.m.

Transformed by God
ROMANS 12:1-21



CHRIS SEIDMAN
Wednesday 7 p.m.

Welcome Others as Christ
ROMANS 15:1-7

FROM GOD,
THROUGH GOD
AND TO GOD
ARE ALL THINGS.

TO GOD BE THE
GLORY FOREVER.

AMEN.

Romans 11:36



Contents

	Theme Speakers	Inside front cover
Welcome one another as Christ has welcomed you	Featured Guests	2
See this quick glance look at the whole program	Schedule Overview	4
These tracks are focused threads of conversation	Tracks	8
	Class Descriptions	15
See who is coming and what they have to say	Participant Photo Index	34
	Meals and Meetings	38-39
Services to make your stay easier	Things to Know.....	40
Sign up early for special events, childcare, and accommodations	Registration	41
	Special Thanks.....	41
See where you are going or get a link to an online map for PDAs	Maps	42-43

www.acu.edu/lectureship

*“Welcome one another just as Christ
has welcomed you”* (ROMANS 15:7)

Featured Guests

We offer the hospitality of Christ to these well-known individuals who will stimulate and challenge our minds and hearts. These guests are sponsored by ACU's Adams Center for Teaching and Learning, Department of Agricultural and Environmental Sciences, Department of Biology, Graduate School of Theology, and the Youth and Family Ministry program.



BRIAN D. McLAREN

Monday 3 p.m.

“Reaching Christians for Christ”

Brian D. McLaren is the author of books such as *A New Kind of Christian* and *More Ready Than You Realize*, an international speaker, and a church planter. He has appeared on “Larry King Live,” “Nightline” and “Religion and Ethics.” He serves as board chair for *Sojourners* magazine. McLaren is an innovative minister who longs for the Christian story to be seen, heard and experienced by an increasingly secular society as truly “good news.”



J. MATTHEW SLEETH

Tuesday 3 p.m.

“Serve God, Save the Planet: A Christian Call to Action”

J. Matthew Sleeth, M.D., resigned as a hospital's chief of medical staff and ER director to lecture, write and preach about creation care and the environment. He is the author of *Serve God, Save the Planet: A Christian Call to Action*. Sleeth is a graduate of George Washington University School of Medicine and has two post-doctoral fellowships. He has been a member of the American Academy of Family Practice, the College of Emergency Physicians and the College of Executive Physicians, but says the most meaningful initials behind his name – M.D. – stand for “My Daddy.”

SAM SOLOMON

Wednesday 3 p.m.

“Sentenced to Death”

A Muslim who converted to Christianity, Sam Solomon is a senior lecturer, research coordinator and adjunct associate for Ravi Zacharias International Ministries. He is CEO of Faith for the Muslims, co-founder of Christian Concern for Our Nation, and a leading British Christian organizer of Lawyers' Christian Fellowship. An authority on Islamic issues with expertise in Shariah law, he has been called to brief world leaders in several nations. Solomon lectures extensively and teaches post-graduate courses for nationals from Muslim countries and missionaries working in the Muslim world.

SUNDAY, SEPTEMBER 21

4:45 P.M.

- ASIA INTEREST GROUP DINNER, BSB 219 (Mission Strategy Room)

7 P.M. OPENING THEME CONVERSATION

- RIGHTEOUSNESS OF GOD REVEALED THROUGH FAITH AND FOR FAITH (ROMANS 1:8-17), Leroy Garrett, Moody Coliseum

8:30 P.M. LATE-NIGHT EVENTS

- CHURCH 2.0: PREACHING, TEACHING AND WORSHIP FOR THE MOBILE GENERATION, Kyle Dickson and Stephen Johnson, Brown Library, Learning Commons
- THE MEN OF ACU: AN A CAPPELLA CHORUS, ACU Faculty, Staff, Alumni and Students, Cullen Auditorium

8:30 P.M. RECEPTIONS

- WORLD CHRISTIAN BROADCASTING RECEPTION, McGlothlin Campus Center, Living Room

MONDAY, SEPTEMBER 22

6:45 A.M. MEALS

- HAITIAN CHRISTIAN FOUNDATION HAITI BREAKFAST, University Church of Christ, Family Room (733 E.N. 16th St.)
- MISSIONS PRAYER BREAKFAST SPONSORED BY MISSIONS RESOURCE NETWORK, McGlothlin Campus Center, Living Room

8:30 A.M. CLASSES

- R&R OF MINISTRY AND MISSIONS, Steve Allison, Jeff Holland, Adams Center Faculty Commons, Classroom
- SEXY SACRIFICES: HAVE WE LAID OUR CHILDREN ON THE ALTAR OF COMMERCIAL CULTURE?, Jennifer Shewmaker, Stephanie Talley, MBB 115
- STONE AND CAMPBELL WANDER THE GROVES OF ACADEME: RESTORATION PRINCIPLES AND UNIVERSITY EDUCATION, Chris Willerton, ACU Students, MBB 117
- NURTURING YOUR BODY TO FEED YOUR MIND AND SPIRIT, Joe D. Bell, BSB 103
- PUTTING EARS ON OUR HEARTS, Jacqueline King, BSB 104
- TRANSCENDENT LEADERSHIP, Margaret J. Weber, BSB 112
- IGLESIAS DE CRISTO, Jorge Daniel Garcia, Patricia Hernandez, BSB 113
- SECOND LIFE? WHAT HAPPENED TO MY FIRST ONE?, David W. Frazee, BSB 114
- A MISSIONAL RESPONSE TO SOCIAL JUSTICE AND POVERTY, Tanya Brice, Darrell Jordan, BSB 115
- KINGDOM LIFE REMIXED: BEYOND THE CHURCH WE'VE KNOWN, John White, BSB 117
- CAMPUS EVANGELISM, CAMPUS REVIVAL AND SPIRITUAL AWAKENING, Jim R. Bevis, BSB 120
- RISEN FROM THE ASHES, Shirley D. Straker, BSB 122
- ADOPTION: REAL-LIFE ADOPTION EXPERIENCES REMIND US WE ARE ALL GOD'S ADOPTED CHILDREN, Kelly Vaughn, BSB 126
- LET MY PEOPLE GO, Bert Reynolds, BSB 127
- ROMANS' PROVERBIAL ROOTS, Glenn Pemberton, BSB 128
- COVENANT RIGHTEOUSNESS IN ROMANS, Thomas H. Olbricht, BSB 129

- LEADERSHIP AND CHURCH GROWTH, Ian Fair, BSB 130
- FIVE THEOLOGICAL TURNINGS PART 1, Brian D. McLaren, BSB 200 (Chapel on the Hill)
- WILL THE REAL GOD PLEASE STAND UP? THE SEARCH FOR JUSTICE IN THE OLD TESTAMENT, Mark Hamilton, BSB 100 (Hart Auditorium)
- BORROWED CREATIVITY, Ginger Morby, WPA, Fulks Theatre

9:45 A.M. CLASSES

- GROWING GLOBAL CHRISTIANS, Joyce Hardin, Adams Center Faculty Commons, Classroom
- CHRISTIAN ACTIVISM, Floyd Rose, MBB 115
- DISCIPLESHIP AND DISCIPLINE WITHIN THE ACADEMY, B. Cole Bennett, Tracy M. Shilcutt, MBB 117
- NOTHING CAN SEPARATE US: GOD'S LOVE FOR THE SAME-SEX STRUGGLER, Sally Gary, BSB 103
- MORE THAN DINNER AT OUR PLACE, Charmé Robarts, BSB 104
- LIVING, LOVING AND LEADING FROM THE HEART, Lee Ann Nutt, BSB 112
- THE MARRIAGE-FRIENDLY PLACE, Beverly Ross, BSB 113
- STROKES FROM A BACKLIT KEYBOARD, Houston Heflin, BSB 114
- GROWING OLD IN CHRIST: BLESSINGS AND CHALLENGES OF MINISTRY TO THE AGING, Jack Holland, BSB 115
- KINGDOM LIFE REMIXED PANEL: THE CONVERSATION CONTINUES, Facilitator: Kent Smith, Panelists: Jared Looney, John White, BSB 117
- WALKING WITH THE SPIRIT: THE TRANSITIONS OF K.C. MOSER, Bobby Valentine, BSB 120
- WORSHIP FOR THE DEAF, Hollis Maynard, BSB 122
- TABLE SCRAPS, Geoffrey Broderick, BSB 126
- OLIVE TREES AND CYBORGS, Jennifer J. Thweatt-Bates, BSB 127
- GOD OF THE MARGINS, Jessica Reese Goudeau, BSB 128
- HOW TO WIN THE WAR AGAINST DRUG ABUSE, Kinwood H. DeVore, BSB 129
- PULLING TOGETHER WITHOUT COMING APART: A PANEL ON ELDER-MINISTER RELATIONSHIPS, Dean Bryce, Malcolm Coco, Eddie Sharp, Jay Spencer, BSB 130
- FIVE THEOLOGICAL TURNINGS, PART 2, Brian D. McLaren, BSB 200 (Chapel on the Hill)

11 A.M. THEME CONVERSATION

- GOD SHOWS NO FAVORITISM (ROMANS 2:1-11), David Fleer, Moody Coliseum

NOON MEALS

- AG MISSIONS LUNCHEON CO-HOSTED BY GLOBAL SAMARITAN RESOURCES, Hillcrest Church of Christ, Family Room (650 E. Ambler Ave.)
- FRIENDS OF THE INTERNATIONAL UNIVERSITY, McGlothlin Campus Center, Living Room
- LET'S START TALKING MINISTRY, McGlothlin Campus Center, East Dining Room

1:30 P.M. HIGHLIGHT CLASSES

- WHAT'S "NEW" ABOUT THE "NEW ATHEISM"?, Rubel Shelly, BSB 200 (Chapel on the Hill)

- **LIFESTYLES OF THE RICH AND AMOS**, Rick Atchley, *BSB 100 (Hart Auditorium)*
- **RELATIONSHIP 101: EIGHT THINGS EVERY LOVER NEEDS TO SAY**, Jeff Walling, *Teague Special Events Center*

3 P.M. FEATURED GUEST

- **REACHING CHRISTIANS FOR CHRIST**, Brian D. McLaren, *Moody Coliseum*

3:30 P.M. MEAL/RECEPTION

- **FRIENDS OF THE ACU LIBRARY BUFFET**, *Brown Library, Learning Commons*

4 P.M. CLASSES

- **CHILDREN OF HELL OR CHILDREN OF HEAVEN?**, Sonny Guild, *Adams Center Faculty Commons, Classroom*
- **THE JUSTICE IMPERATIVE**, Robert L. Foster, *MBB 115*
- **WE ARE WHAT WE THINK!**, Becky Holton, *MBB 117*
- **COMMUNICATION – THE FOUNDATION OF EFFECTIVE LEADERSHIP**, Taylor A. McKenzie, *BSB 103*
- **WOMEN'S VIOLENCE IN GLOBAL POLITICS**, Caron E. Gentry, *BSB 112*
- **WHAT LANGUAGE MAY I BORROW?**, Ron Highfield, *BSB 113*
- **INSIDE THE YOUTH MINISTER'S STUDIO WITH BRIAN McLAREN**, Robert Oglesby Jr., *BSB 114*
- **FIGHTING FOR JUSTICE**, Brandon James Smith, *BSB 115*
- **HOW VISUAL MEDIA SAVED MY LIFE**, Rob Thomas, *BSB 117*
- **SHOW US HOW YOU DO IT**, Edward J. Robinson, *BSB 120*
- **SPIRITUAL CPR FOR A DYING GENERATION**, Dan Cooke, *BSB 127*
- **WHEN PEACE BREAKS OUT**, Joey Cope, *BSB 128*
- **EMERGING ELDERS**, Ron Clark, *BSB 129*
- **TRANSCENDING RACISM**, Douglas A. Foster, *BSB 130*
- **CONQUEST: FINDING YOUR PLACE IN GOD'S MISSION**, Scott Sager, *BSB 200 (Chapel on the Hill)*

5 P.M. MEALS

- **AFRICAN MISSIONS FELLOWSHIP DINNER**, *University Church of Christ, Family Room*
- **CHRISTIAN CHILD AND FAMILY SERVICES ASSOCIATION DINNER**, *Briarstone Manor (101 Eplen Court)*
- **CONTINENT OF GREAT CITIES DINNER**, *University Church of Christ, Ministry Activity Center (733 E.N. 16th St.)*
- **MISSION ALIVE DINNER**, *WPA, Lobby*
- **SUNSET INTERNATIONAL BIBLE INSTITUTE DINNER**, *McGlothlin Campus Center, Living Room*

7 P.M. THEME CONVERSATION

- **GOD'S RIGHTEOUSNESS FOR SINNERS (ROMANS 3:21-26)**, J. Kevin Murray, *Moody Coliseum*

8:30 P.M. LATE-NIGHT EVENTS

- **EMPTY BOWLS: ART AND SOUP FOR THE HUNGRY (IRON POUR EVENT)**, *The grassy area west of Teague Special Events Center*
- **UNTOUCHABLE: PAUL'S JOURNEY FROM HITMAN TO APOSTLE**, Larry Mudd, *Brown Library, Learning Commons*

8:30 P.M. RECEPTIONS

- **YORK COLLEGE FRIENDS AND ALUMNI RECEPTION**, *McGlothlin Campus Center, Living Room*

TUESDAY, SEPTEMBER 23

7 A.M. MEALS

- **HERALD OF TRUTH MINISTRIES**, *McGlothlin Campus Center, Living Room*
- **RESTORATION QUARTERLY BREAKFAST**, *University Church of Christ, Family Room (733 E.N. 16th St.)*
- **WORLD BIBLE SCHOOL BREAKFAST**, *WPA, Lobby*

8:30 A.M. CLASSES

- **R&R OF MINISTRY AND MISSIONS**, Steve Allison, Jeff Holland, *Adams Center Faculty Commons, Classroom*
- **NO PASSPORT NEEDED**, Casey McCollum, Steve Sargent, *Brown Library, Mabee Library Auditorium*
- **SEXY SACRIFICES: HAVE WE LAID OUR CHILDREN ON THE ALTAR OF COMMERCIAL CULTURE?**, Jennifer Shewmaker, Stephanie Talley, *MBB 115*
- **STONE AND CAMPBELL WANDER THE GROVES OF ACADEME: RESTORATION PRINCIPLES AND UNIVERSITY EDUCATION**, Chris Willerton and ACU Students, *MBB 117*
- **ALREADY BUT NOT YET**, Edward Fudge, *BSB 103*
- **WHO ARE THESE PEOPLE? LABORERS ALONGSIDE THE LOCAL CHURCH**, Linda A. King, *BSB 104*
- **TRANSCENDENT LEADERSHIP**, Margaret J. Weber, *BSB 112*
- **CONFORMED TO THE IMAGE OF HIS SON**, Steven Carrizal, *BSB 113*
- **A DIALOGUE WITH THE CHRISTIAN CHRONICLE**, Lynn A. McMillon, *BSB 114*
- **A MISSIONAL RESPONSE TO SOCIAL JUSTICE AND POVERTY**, Tanya Brice, Darrell Jordan, *BSB 115*
- **KINGDOM LIFE REMIXED: NETWORKING SIMPLICITY**, John White, *BSB 117*
- **CAMPUS EVANGELISM, CAMPUS REVIVAL AND SPIRITUAL AWAKENING**, Jim R. Bevis, *BSB 120*
- **RISEN FROM THE ASHES**, Shirley D. Straker, *BSB 122*
- **ADOPTION: REAL-LIFE ADOPTION EXPERIENCES REMIND US WE ARE ALL GOD'S ADOPTED CHILDREN**, Kelly Vaughn, *BSB 126*
- **LET MY PEOPLE GO**, Bert Reynolds, *BSB 127*
- **ROMANS' PROVERBIAL ROOTS**, Glenn Pemberton, *BSB 128*
- **COVENANT RIGHTEOUSNESS IN ROMANS**, Thomas H. Olbricht, *BSB 129*
- **LEADERSHIP AND CHURCH GROWTH**, Ian Fair, *BSB 130*
- **WILL THE REAL GOD PLEASE STAND UP? THE SEARCH FOR JUSTICE IN THE OLD TESTAMENT**, Mark Hamilton, *BSB 100 (Hart Auditorium)*
- **MATTHEW SLEETH'S DIALOGUE WITH ECOLOGY STUDENTS**, Matthew Sleeth, *BSB 200 (Chapel on the Hill)*

9:45 A.M. CLASSES

- **HOW LONG CAN YOU TREAD WATER?**, Larry Henderson, *Adams Center Faculty Commons, Classroom*
- **REFLECTIONS ON YOUTH MINISTRY**, Facilitator: Robert Oglesby Jr., *Brown Library, Mabee Library Auditorium*

- **CHRISTIAN ACTIVISM**, Floyd Rose, *MBB 115*
- **DISCIPLESHIP AND DISCIPLINE WITHIN THE ACADEMY**, B. Cole Bennett, Tracy M. Shilcutt, *MBB 117*
- **NOTHING CAN SEPARATE US: GOD'S LOVE FOR THE SAME-SEX STRUGGLER**, Sally Gary, *BSB 103*
- **CHRISTIAN FINANCES – AN OXYMORON**, Scott K. Stegall, *BSB 104*
- **LIVING, LOVING AND LEADING FROM THE HEART** Lee Ann Nutt , *BSB 112*
- **A LAW UNTO THEMSELVES**, Kenny Jones, *BSB 113*
- **AT WORK IN THE FIELDS OF THE LORD: BEING A CHAPLAIN TO A SECULAR UNIVERSITY**, Robert M. Randolph, *BSB 114*
- **GROWING OLD IN CHRIST: BLESSINGS AND CHALLENGES OF MINISTRY TO THE AGING**, Jack Holland, *BSB 115*
- **KINGDOM LIFE REMIXED PANEL: THE CONVERSATION CONTINUES**, Facilitator: Kent Smith, Panelists: Jared Looney, John White, *BSB 117*
- **WALKING WITH THE SPIRIT: THE TRANSITIONS OF K.C. MOSER**, Bobby Valentine, *BSB 120*
- **CONTENT FOR BIBLE CLASSES FOR THE DEAF**, Larry Prince, *BSB 122*
- **MISSIONARY CARE**, Dorris M. Schulz, *BSB 126*
- **OLIVE TREES AND CYBORGS**, Jennifer J. Thweatt-Bates, *BSB 127*
- **TENACIOUS HOSPITALITY: WELCOMING THE UNWELCOMED**, MaLesia Breeding, Dana Hood, *BSB 128*
- **HOW TO WIN THE WAR AGAINST DRUG ABUSE ...** , Kinwood H. DeVore, *BSB 129*
- **PULLING TOGETHER WITHOUT COMING APART: A PANEL ON ELDER-MINISTER RELATIONSHIPS**, Dean Bryce, Malcolm Coco, Eddie Sharp, Jay Spencer, *BSB 130*
- **"BUT I WAS JUST PREACHING!" PROCLAIMING JUSTICE AND HOPE FROM THE OLD TESTAMENT**, Mark Hamilton, Stephen Johnson, Tim Sensing, *BSB 100 (Hart Auditorium)*
- **BORROWED CREATIVITY**, Ginger Morby, *WPA, Fulks Theatre*

11 A.M. THEME CONVERSATION

- **SIN CONDEMNED IN CHRIST JESUS (ROMANS 8:1-11)**, James Thompson, *Moody Coliseum*

NOON MEALS

- **CANADA: MISSION OPPORTUNITIES SPONSORED BY GREAT LAKES CHRISTIAN COLLEGE AND WESTERN CHRISTIAN COLLEGE**, *McGlothlin Campus Center, Living Room*
- **HALBERT INSTITUTE FOR MISSIONS LUNCHEON**, *WPA, Lobby*
- **"SEEING THE BIBLE THROUGH THE EYES OF THE ARTIST" Artist Brown Bag Sponsored by ACU Art and Design Department**, *Don H. Morris Center, Shore Art Gallery*

1:30 P.M. HIGHLIGHT CLASSES

- **WHY BELIEVING IS SEEING**, Rubel Shelly, *BSB 200 (Chapel on the Hill)*
- **LIFESTYLES OF THE RICH AND AMOS**, Rick Atchley, *BSB 100 (Hart Auditorium)*
- **RELATIONSHIP 101: EIGHT THINGS EVERY LOVER NEEDS TO SAY**, Jeff Walling, *Teague Special Events Center*

3 P.M. FEATURED GUEST

- **SERVE GOD SAVE THE PLANET**, J. Matthew Sleeth, *Moody Coliseum*

4 P.M. CLASSES

- **CHILDREN OF HELL OR CHILDREN OF HEAVEN?**, Sonny Guild, *Adams Center Faculty Commons, Classroom*
- **THE JUSTICE IMPERATIVE**, Robert L. Foster, *MBB 115*
- **WE ARE WHAT WE THINK!**, Becky Holton, *MBB 117*
- **COMMUNICATION – THE FOUNDATION OF EFFECTIVE LEADERSHIP**, Taylor A. McKenzie, *BSB 103*
- **WOULD THE APOSTLE PAUL USE THE INTERNET? MISSIONS IN A WIRED WORLD**, Steve Austin, *BSB 104*
- **THE GOD-PRAISING AND EARTH-CARING COMMUNITY**, Eric Yates, *BSB 112*
- **NEW HYMNS, OLD PROBLEMS**, Jack Boyd, *BSB 113*
- **AT WORK IN THE FIELDS OF THE LORD: BEING A CHAPLAIN TO A SECULAR UNIVERSITY**, Robert M. Randolph, *BSB 114*
- **THE VIOLENCE OF LOVE**, Matthew Ryan Worthington, *BSB 115*
- **REDEFINING CHRISTIANISM**, Matt Wallace, Nikki Wallace, *BSB 117*
- **THREE DECISIVE DATES FOR CHURCHES OF CHRIST**, Douglas A. Foster, *BSB 120*
- **MULTICULTURALISM AND DIVERSITY: THE 21ST CENTURY CHALLENGES FOR THE CHURCH**, George Pendergrass, *BSB 127*
- **WHEN PEACE BREAKS OUT**, Joey Cope, *BSB 128*
- **EMERGING ELDERS**, Ron Clark, *BSB 129*
- **MOVING BEYOND WHITE JESUS (TRANSCENDING RACISM)**, Travis Stanley, Walter L. Taylor, *BSB 130*
- **CONQUEST: FINDING YOUR PLACE IN GOD'S MISSION**, Scott Sager, *BSB 200 (Chapel on the Hill)*

4:45 P.M. MEALS

- **MEN'S FELLOWSHIP DINNER**, *University Church of Christ, Ministry Activity Center (733 E.N. 16th St.)*
- **WOMEN FOR ACU DINNER**, *WPA, Lobby*

6 P.M. RECEPTION

- **"THE BIBLE AND THE ARTISTS OF THE 20TH CENTURY" Gallery Talk and Tour Sponsored by ACU Art and Design Department**, *Don H. Morris Center, Shore Art Gallery*

7 P.M. THEME CONVERSATION

- **FROM GOD, THROUGH GOD AND TO GOD ARE ALL THINGS (ROMANS 11:25-36)**, Randy Harris, *Moody Coliseum*

8:30 P.M. LATE-NIGHT EVENTS

- **MUSICA ROMANA**, ACU Music Department Faculty, *WPA, Recital Hall*
- **"THE GOLDEN COMPASS": RESPONDING TO THE BOOK WHERE THEY KILL GOD**, Shelly Sanders with ACU Students, *Brown Library, Learning Commons*

8:30 P.M. RECEPTIONS

- **ROCHESTER COLLEGE FRIENDS AND ALUMNI RECEPTION**, *McGlothlin Campus Center, Living Room*

WEDNESDAY, SEPTEMBER 24

8:30 A.M. CLASSES

- **ALREADY BUT NOT YET**, Edward Fudge, *BSB 103*
- **WHO ARE THESE PEOPLE? LABORERS ALONGSIDE THE LOCAL CHURCH**, Linda A. King, *BSB 104*
- **ONE CHURCH'S METHOD FOR EMBRACING NEW MEMBERS**, Doug Brown, *BSB 112*
- **MY BROTHER Y MI HERMANO**, Jorge Daniel Garcia, Patricia Hernandez, *BSB 113*
- **CONFESS AND BELIEVE JESUS CHRIST IS THE LORD (ROMANS 10:9)**, Bob Fu, *BSB 114*
- **A MISSIONAL RESPONSE TO SOCIAL JUSTICE AND POVERTY**, Tanya Brice, Darrell Jordan, *BSB 115*
- **KINGDOM LIFE REMIXED: RE-ENVISIONING KINGDOM LEADERSHIP**, John White, *BSB 117*
- **CAMPUS EVANGELISM, CAMPUS REVIVAL AND SPIRITUAL AWAKENING**, Jim R. Bevis, *BSB 120*
- **ADOPTION: REAL-LIFE ADOPTION EXPERIENCES REMIND US THAT WE ARE ALL GOD'S ADOPTED CHILDREN**, Kelly Vaughn, *BSB 126*
- **LET MY PEOPLE GO**, Bert Reynolds, *BSB 127*
- **FRESH FACE ON THE ANCIENT TALE**, Larry Mudd, *BSB 128*
- **COVENANT RIGHTEOUSNESS IN ROMANS**, Thomas H. Olbricht, *BSB 129*
- **LEADERSHIP AND CHURCH GROWTH**, Ian Fair, *BSB 130*
- **DECEPTION**, Sam Solomon, *BSB 200 (Chapel on the Hill)*
- **WILL THE REAL GOD PLEASE STAND UP? THE SEARCH FOR JUSTICE IN THE OLD TESTAMENT**, Mark Hamilton, *BSB 100 (Hart Auditorium)*

9:45 A.M. CLASSES

- **HOW LONG CAN YOU TREAD WATER?**, Larry Henderson, *Adams Center Faculty Commons, Classroom*
- **NOTHING CAN SEPARATE US: GOD'S LOVE FOR THE SAME-SEX STRUGGLER**, Sally Gary, *BSB 103*
- **OCULUS DEI**, Greg Kendall-Ball, *BSB 104*
- **PICKING UP A PLUNGER**, Kayci Ross, *BSB 112*
- **GOSPEL GRAFFITI**, Kevin J. Youngblood, *BSB 113*
- **CONFESS AND BELIEVE JESUS CHRIST IS THE LORD (ROMANS 10:9)**, Bob Fu, *BSB 114*
- **GROWING OLD IN CHRIST: BLESSINGS AND CHALLENGES OF MINISTRY TO THE AGING**, Jack Holland, *BSB 115*
- **KINGDOM LIFE REMIXED PANEL: THE CONVERSATION CONTINUES**, Facilitator: Kent Smith, Panelists: Jared Looney, John White, *BSB 117*
- **WALKING WITH THE SPIRIT: THE TRANSITIONS OF K.C. MOSER**, Bobby Valentine, *BSB 120*
- **FUNDRAISING FOR SAM'S PLACE**, Vernon Williams, *BSB 122*
- **OLIVE TREES AND CYBORGS**, Jennifer J. Thweatt-Bates, *BSB 127*
- **TENACIOUS HOSPITALITY: WELCOMING THE UNWELCOMED**, MaLesa Breeding, Dana Hood, *BSB 128*
- **HOW TO WIN THE WAR AGAINST DRUG ABUSE**, Kinwood H. DeVore, *BSB 129*

- **PULLING TOGETHER WITHOUT COMING APART: A PANEL ON ELDER-MINISTER RELATIONSHIPS**, Dean Bryce, Malcolm Cocco, Eddie Sharp, Jay Spencer, *BSB 130*
- **DEMOLITION**, Sam Solomon, *BSB 200 (Chapel on the Hill)*
- **"BUT I WAS JUST PREACHING!" PROCLAIMING JUSTICE AND HOPE FROM THE OLD TESTAMENT**, Mark Hamilton, Stephen Johnson, Tim Sensing, *BSB 100 (Hart Auditorium)*

11 A.M. THEME CONVERSATION

- **TRANSFORMED BY GOD (ROMANS 12:1-21)**, Eric L. Wilson, *Moody Coliseum*

NOON MEALS

- **GRADUATE SCHOOL OF THEOLOGY ALUMNI LUNCHEON**, *WPA, Lobby*

1:30 P.M. HIGHLIGHT CLASSES

- **LIFESTYLES OF THE RICH AND AMOS**, Rick Atchley, *BSB 100 (Hart Auditorium)*
- **RELATIONSHIP 101: EIGHT THINGS EVERY LOVER NEEDS TO SAY**, Jeff Walling, *Teague Special Events Center*

3 P.M. FEATURED GUEST

- **SENTENCED TO DEATH**, Sam Solomon, *Moody Coliseum*

4 P.M. CLASSES

- **NEW HYMNS, OLD PROBLEMS**, Jack Boyd, *BSB 103*
- **WOULD THE APOSTLE PAUL USE THE INTERNET? MISSIONS IN A WIRED WORLD**, Steve Austin, *BSB 104*
- **THE GOD-PRAISING AND EARTH-CARING COMMUNITY**, Eric Yates, *BSB 112*
- **CHRISTIAN DIGITAL ENTERTAINMENT**, Brian G. Burton, *BSB 113*
- **CONFESS AND BELIEVE JESUS CHRIST IS THE LORD (ROMANS 10:9)**, Bob Fu, *BSB 114*
- **SEX, LIES AND RELATIONSHIPS**, Anna Peters, *BSB 115*
- **REDEFINING CHRISTIANISM**, Matt Wallace, Nikki Wallace, *BSB 117*
- **WOMEN'S VIOLENCE IN GLOBAL POLITICS**, Caron E. Gentry, *BSB 120*
- **MULTICULTURALISM AND DIVERSITY: THE 21ST CENTURY CHALLENGES FOR THE CHURCH**, George Pendergrass, *BSB 127*
- **WHEN PEACE BREAKS OUT**, Joey Cope, *BSB 128*
- **EMERGING ELDERS**, Ron Clark, *BSB 129*
- **NEWFOUND AWARENESS (TRANSCENDING RACISM)**, Damon Parker, Beatriz Alem Walker, *BSB 130*
- **CONQUEST: FINDING YOUR PLACE IN GOD'S MISSION**, Scott Sager, *BSB 200 (Chapel on the Hill)*

7 P.M. THEME CONVERSATION

- **WELCOME OTHERS AS CHRIST (ROMANS 15:1-7)**, Chris Seidman, *Moody Coliseum*

Student Track

BSB – Onstead-Packer Biblical Studies Building
MBB – Mabee Business Building

The current generation of believers on our campus provided leadership for this Emergent Faith track. These classes, topics and speakers were selected by ACU students.

Reaching Christians for Christ

Monday, 3 p.m., Moody Coliseum
Brian D. McLaren

Serve God, Save the Planet: A Christian Call to Action

Tuesday, 3 p.m., Moody Coliseum
J. Matthew Sleeth

Sentenced to Death

Wednesday, 3 p.m., Moody Coliseum
Sam Solomon

Transcending Racism

Monday-Tuesday-Wednesday, 4 p.m., BSB 130
Monday: Douglas A. Foster
Tuesday: Travis Stanley, Walter L. Taylor
Wednesday: Damon Parker, Beatriz Alem Walker

Confess and Believe Jesus Christ is the Lord: Persecution and Faith in China

Wednesday, 8:30 a.m., 9:45 a.m., 4 p.m., BSB 114
Bob Fu

Lifestyles of the Rich and Amos: Why Rich Religion Gets It Wrong

Monday-Tuesday-Wednesday, 1:30 p.m., BSB 100 (Hart Auditorium)
Rick Atchley



ACU students Brian Escochea and Shelby Jackson



Student Winner

ACU student James Davies is the winner of our 2008 student art and photo contest. Students submitted photos visually depicting the theme of Summit: "The Righteousness of God."

Student Track

BSB – Onstead-Packer Biblical Studies Building
MBB – Mabee Business Building

The current generation of believers on our campus provided leadership for this Emergent Faith track. These classes, topics and speakers were selected by ACU students.

Reaching Christians for Christ

Monday, 3 p.m., Moody Coliseum
Brian D. McLaren

Serve God, Save the Planet: A Christian Call to Action

Tuesday, 3 p.m., Moody Coliseum
J. Matthew Sleeth

Sentenced to Death

Wednesday, 3 p.m., Moody Coliseum
Sam Solomon

Transcending Racism

Monday-Tuesday-Wednesday, 4 p.m., BSB 130
Monday: Douglas A. Foster
Tuesday: Travis Stanley, Walter L. Taylor
Wednesday: Damon Parker, Beatriz Alem Walker

Confess and Believe Jesus Christ is the Lord: Persecution and Faith in China

Wednesday, 8:30 a.m., 9:45 a.m., 4 p.m., BSB 114
Bob Fu

Lifestyles of the Rich and Amos: Why Rich Religion Gets It Wrong

Monday-Tuesday-Wednesday, 1:30 p.m., BSB 100 (Hart Auditorium)
Rick Atchley

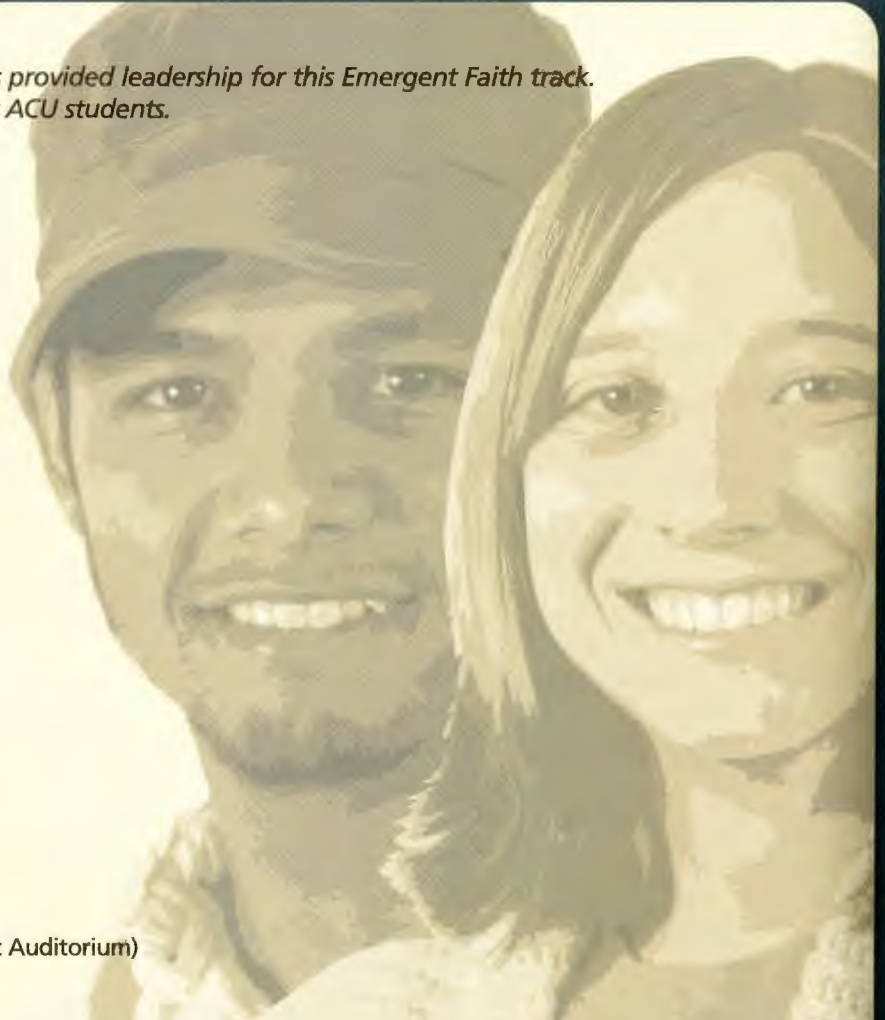

ACU students Brian Escochea and Shelby Jackson



Student Winner

ACU student James Davies is the winner of our 2008 student art and photo contest. Students submitted photos visually depicting the theme of Summit: "The Righteousness of God."

Student Track

Stone and Campbell Wander the Groves of Academe: Restoration Principles and University Education

Monday-Tuesday, 8:30 a.m., MBB 117
Chris Willerton and ACU Students

Relationship 101: Eight Things Every Lover Needs to Say

Monday-Tuesday-Wednesday, 1:30 p.m.,
Teague Special Events Center
Jeff Walling

Fighting for Justice: The Role of the Church in the 21st Century

Monday, 4 p.m., BSB 115
Brandon James Smith

How to Win the War Against Drug Abuse

Monday-Tuesday-Wednesday, 9:45 a.m., BSB 129
Kinwood H. DeVore

The Violence of Love: What It Means to Be a Better Lover in Light of a Not-So-Loving World

Tuesday, 4 p.m., BSB 115
Matthew Ryan Worthington

Sex, Lies and Relationships

Wednesday, 4 p.m., BSB 115
Anna Peters

Romans' Proverbial Roots

Monday-Tuesday, 8:30 a.m., BSB 128
Glenn Pemberton

ACU students Jaz Maranca and Chris Morris

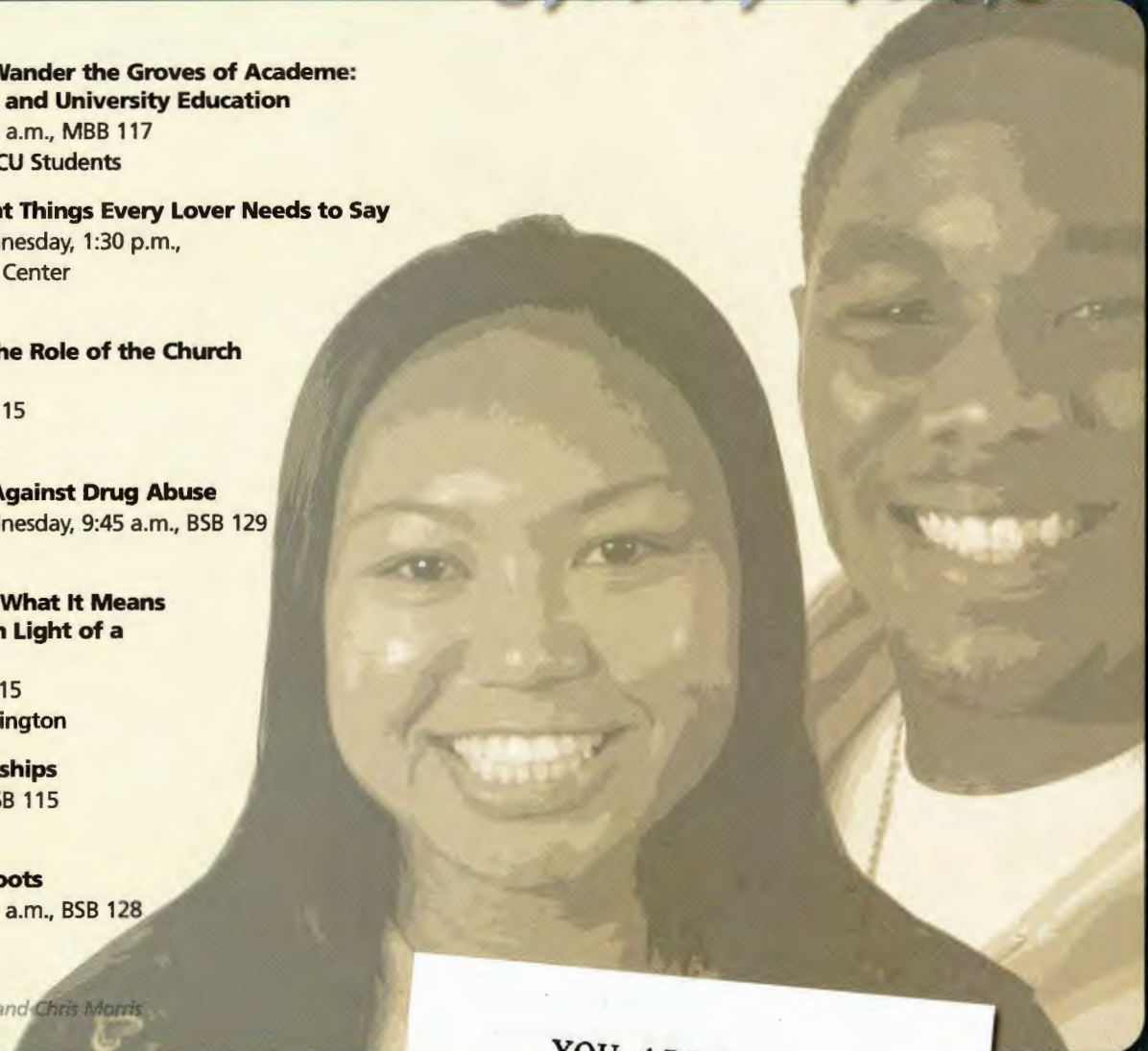

YOU ARE INVITED

to attend

BIBLE LECTURE WEEK

at

ABILENE CHRISTIAN COLLEGE

FEBRUARY 20-27

You will be the guests of Abilene Christian College and the congregations of the church of Christ in Abilene, Texas.

Bible Lecture Week

The last week of each February is given to a series of lectures on biblical themes by the strongest and most efficient men to be found among members of the churches of Christ. These lectures are provided for the special benefit of our students. But we are always glad to have the friends of Abilene Christian College present to enjoy this rich feast of spiritual things.

There will be three lectures daily, excepting Monday and Saturday. (See the accompanying program.) In addition to these lectures there will be many other features of interest. Those who have the privilege of attending see Abilene Christian College in action. They meet our students in classroom, on the play ground and in public meetings. This provides a means of becoming acquainted with what is being done here more directly and more exactly than any other that could be furnished. Other special features are arranged especially for the benefits of those who accept this invitation to come and be at home with us during this week, special programs, special songs, etc.

These are all arranged for your benefit and for your enjoyment. We are anxious to have you here. Come and get acquainted with us. Let's get closer together.

A Piece of History

This Lectureship brochure from 1921 is the oldest we possess. Notice the original purpose was to benefit students and their learning experience. In the 1920s, students considered Lectureship "the nucleus of the school term." Students, thanks for your help and welcome back to a new Lectureship known as "Summit."

Life and Ministry

BSB – Onstead-Packer Biblical Studies Building

Life and ministry are not separate categories of service but describe every Christian's journey. While some Christians take their livelihood from ministry, every Christian lives in ministry. The context of our lives is the space God has given us to creatively express the gospel in every moment. This track is intended for those interested in daily discipleship and equipping people for ministry and service.

Tenacious Hospitality: Welcoming the Unwelcomed

Tuesday-Wednesday, 9:45 a.m., BSB 128
MaLesa Breeding and Dana Hood

Pulling Together Without Coming Apart: A Panel on Elder-Minister Relationships

Monday-Tuesday-Wednesday, 9:45 a.m., BSB 130
Dean Bryce, Malcolm Coco, Eddie Sharp, Jay Spencer

One Church's Method for Embracing New Members

Wednesday, 8:30 a.m., BSB 113
Doug Brown

Emerging Elders

Monday-Tuesday-Wednesday, 4 p.m., BSB 129
Ron Clark

When Peace Breaks Out

Monday-Tuesday-Wednesday, 4 p.m., BSB 128
Joey Cope

Leadership and Church Growth

Monday-Tuesday-Wednesday, 8:30 a.m., BSB 130
Ian Fair

Transcendent Leadership

Monday-Tuesday, 8:30 a.m., BSB 112
Margaret J. Weber

Who Are All These People?

Laborers Alongside the Local Church

Tuesday-Wednesday, 8:30 a.m., BSB 104
Linda A. King

God of the Margins: The Church and the Rhetoric of Illegal Immigration

Monday, 9:45 a.m., BSB 128
Jessica Reese Goudeau

Communication – The Foundation of Effective Leadership

Monday-Tuesday, 4 p.m. BSB 103
Taylor A. McKenzie

Living, Loving and Leading from the Heart: Leadership Realities Facing Christian Women

Monday-Tuesday, 9:45 a.m., BSB 112
Lee Ann Nutt

Multiculturalism and Diversity: The 21st Century Challenges for the Church

Tuesday-Wednesday, 4 p.m., BSB 127
George Pendergrass

Christian Finances – An Oxymoron?

Tuesday, 9:45 a.m., BSB 104
Scott K. Stegall

Our Future History

The history of the Stone-Campbell movement is not restricted to the past but is a true "movement" into the future God has planned for humanity and creation. These classes embrace and explore this rich history as a viable future.

Campus Evangelism, Campus Revival and Spiritual Awakening

Monday-Tuesday-Wednesday, 8:30 a.m., BSB 120
Jim R. Bevis

Walking with the Spirit: The Transitions of K.C. Moser

Monday-Tuesday-Wednesday, 9:45 a.m., BSB 120
Bobby Valentine

Three Decisive Dates for Churches of Christ: The Pivotal Events of 1809, 1909 and 2009

Tuesday, 4 p.m., BSB 120
Douglas A. Foster

Show Us How You Do It: Marshall Keeble and the Rise of Black Churches of Christ in the United States

Monday, 4 p.m., BSB 120
Edward J. Robinson



Marshall Keeble

Spiritual Formation

The practices of spiritual discipline are invaluable to the lives of Christians. These classes and experiences explore the art of seeking God in every moment of life.

Putting Ears on Our Hearts: A Prayer Retreat for Hearing God Within

Monday, 8:30 a.m., BSB 104

Jacqueline King

More Than Dinner at Our Place: The Reconciling Work of Living Hospitably

Monday, 9:45 a.m., BSB 104

Charne Roberts

Already But Not Yet: Living in the Overlap

Tuesday-Wednesday, 8:30 a.m., BSB 103

Edward Fudge

Morning Prayers at *Jacob's Dream*

Monday-Tuesday-Wednesday, 8 a.m.

Brady Bryce

*Jacob's Dream sculpture
on the campus of
Abilene Christian University*

Justice and Mercy

The terminology of justice and mercy is not reserved for the church house, but the performance of justice and the love of mercy must be lived in our world. Jesus called us to sacrifice, mercy and love. These classes encourage Christians to take justice from the pages of scripture and live them in the routines of life.

A Missional Response to Social Justice and Poverty

Monday-Tuesday-Wednesday, 8:30 a.m., BSB 115

Tanya Brice, Darrell Jordan

Oculus Dei: Photography as Ministry

Wednesday, 9:45 a.m., BSB 104

Greg Kendall-Ball

Fighting for Justice: The Role of the Church in the 21st Century

Monday, 4 p.m., BSB 115

Brandon James Smith

Transcending Racism

Monday-Tuesday-Wednesday, 4 p.m., BSB 130

Monday: Douglas A. Foster

Tuesday: Travis Stanley, Walter L. Taylor

Wednesday: Damon Parker, Beatriz Alem Walker

Confess and Believe Jesus Christ is the Lord: Persecution and Faith in China

Wednesday, 8:30 a.m., 9:45 a.m., 4 p.m., BSB 114

Bob Fu

The Violence of Love: What It Means to Be a Better Lover in Light of a Not-So-Loving World

Tuesday, 4 p.m., BSB 115

Matthew Ryan Worthington

Art and Faith

BSB – Onstead-Packer Biblical Studies Building
WPA – Williams Performing Arts Center

The art and design, music, and theatre departments contribute in powerfully moving ways to the theology of our churches. These classes explore how the arts can express faith and converse with the world about the mysteries of a life modeled by Jesus.

Tablescrap: The Art of Self Denial

Monday, 9:45 a.m., BSB 126
Geoffrey Broderick

A Law Unto Themselves: Spiritual Lessons from Contemporary Art

Tuesday, 9:45 a.m., BSB 113
Kenny Jones

Borrowed Creativity: The Artist's Calling to an Original Life

Monday, 8:30 a.m. and Tuesday 9:45 a.m., WPA, Fulks Theatre
Ginger Morby

How Visual Media Saved My Life

Monday, 4 p.m., BSB 112
Rob Thomas

Gospel Graffiti: Reflections on Defacing the Art of God

Wednesday, 9:45 a.m., BSB 113
Kevin J. Youngblood

PERFORMANCE

MUSICA ROMANA: *Fifteen Centuries of Roman Music*

This concert features a musical journey through the last millennium in celebration of the heritage and inspiration of Rome, the Eternal City. Experience the Old Roman Chant, the Renaissance a cappella tradition, Italian Impressionism, modern chamber music, and a reconstruction of pagan music from antiquity.

Seating is limited for one show Tuesday at 8:30 p.m. in the Recital Hall of the Williams Performing Arts Center.

Free tickets are available by calling 325-674-2462.

THE ARTIST AND THE BIBLE: *Twentieth Century Works on Paper*

This unique collection includes internationally renowned artists: Pablo Picasso, Georges Roualt, Fernand Leger, Marc Chagall, Kathe Kollwitz and Ben Zion, among others. Gallery visitors will see prints and drawings depicting biblical stories – the nativity, the years of Jesus' teaching, ministry to the poor and sick, and on to the crucifixion and resurrection. Guided tours are available; contact gallery director Garlan Jenkins at 325-674-4896 or Garlan.Jenkins@acu.edu.



Don H. Morris Center, Shore Art Gallery
Exhibit open Monday-Friday, 9 a.m. - 5 p.m.

Artist Brown Bag: Tuesday, noon,
"Seeing the Bible Through the Eyes
of the Artist"

Gallery Talk and Tour: Tuesday, 6-6:45 p.m.
"The Bible and Artists of the 20th Century"

Gospel and Culture

People of faith wrestle to express the gospel with our lives in a postmodern world. How does the gospel connect with the world? The world is increasingly ignorant of or hostile to Christianity, yet at the same time there is a growing spiritual awareness represented in movies, television and books. These classes explore how Christ addresses culture and is found within culture.

Would the Apostle Paul Use the Internet? Missions in a Wired World

Tuesday-Wednesday, 4 p.m., BSB 104

Steve Austin

Kingdom Life Remixed: Beyond the Church We've Known

Monday-Tuesday-Wednesday, 8:30 and 9:45 a.m., BSB 117

Jared Looney, Kent Smith, John White

Redefining Christianity

Tuesday-Wednesday, 4 p.m., BSB 117

Matt Wallace, Nikki Wallace

The God-Praising and Earth-Caring Community

Tuesday-Wednesday, 4 p.m., BSB 112

Eric Yates

How to Win the War Against Drug Abuse

Monday-Tuesday-Wednesday, 9:45 a.m., BSB 129

Kinwood H. DeVore

COFFEE HOUSE PRESENTATIONS

All events will take place in the Learning Commons of Brown Library.

🌀 Interactive Presentation:

Church 2.0: Preaching, Teaching and Worship for the Mobile Generation

Sunday, 8:30 p.m.

Kyle Dickson, Stephen Johnson

🌀 Performance:

Untouchable: Paul's Journey from Hitman to Apostle

Monday, 8:30 p.m.

Larry Mudd

🌀 Panel:

"The Golden Compass": Responding to the Book Where They Kill God

Tuesday, 8:30 p.m.

Shelly Sanders with ACU students

BSB – Onstead-Packer Biblical Studies Building

Youth Ministry

The youth in our churches have an emerging faith that is already shaping our churches. Youth ministers explore teen ministry and issues of youth in these classes.

Second Life? What Happened to My First One?

Monday, 8:30 a.m., BSB 114

David W. Frazee

Strokes from a Backlit Keyboard: Reading Romans in the Ambient Light of Youth Culture

Monday, 9:45 a.m., BSB 114

Houston Heflin

Reaching Christians for Christ

Monday, 3 p.m., Moody Coliseum

Brian D. McLaren

Inside the Youth Minister's Studio with Brian McLaren

Monday, 4 p.m., BSB 114

Robert Oglesby Jr., facilitator

No Passport Needed: Moving Beyond Service to Social Justice

Tuesday, 8:30 a.m., BSB 114

Casey McCollum, Steve Sargent

Reflections on Youth Ministry: A Special Session Designed for Youth Ministers and Youth Ministry Students

Tuesday, 9:45 a.m., BSB 114

Robert Oglesby Jr., facilitator



Opening Night: THEME CONVERSATION

RIGHTEOUSNESS OF GOD REVEALED THROUGH FAITH AND FOR FAITH Romans 1:8-17

7 p.m., Moody Coliseum

Worship Leader: *George Pendergrass (Abilene, Texas)*

Leroy Garrett (Denton, Texas) 82107-01

CHURCH 2.0: PREACHING, TEACHING AND WORSHIP FOR THE MOBILE GENERATION

8:30 p.m., Brown Library, Learning Commons

Kyle Dickson (Abilene, Texas) and Stephen Johnson

(Abilene, Texas) 82108-01

Coffee House with Kyle Dickson and Stephen Johnson

- "Church 2.0: Preaching, Teaching and Worship for the Mobile Generation"
- Sunday, 8:30 p.m.
- Brown Library, Learning Commons

THE MEN OF ACU: An A Cappella Chorus

8:30 p.m., Cullen Auditorium

ACU Faculty, Staff, Alumni and Students

SUNDAY

September 28



From the Director

Friends,

Thanks for your interest and participation in this great program. As the new director of ministry events, I invite you to experience Summit as the new Lectureship on our campus.

This historic event has 100 of history, beginning in January 1907 as a weeklong gospel meeting for students. Now in 2008, Summit is a "conversation where life and faith converge in Christ," a time when thousands of Christians gather at ACU for the longest-running annual program in Churches of Christ.

This year we welcome friends, guests, students, faculty, alumni and those who are new to this event. We intend for your time at ACU to be one that encourages you to look like Christ and live out God's mission in your home town.

We give our attention to the exploration of "The Righteousness of God," which is both a gift of God and a way of life for His people. So, let's enjoy this time together and live out Paul's words: "welcome one another just as Christ has received you." (Romans 15:7)

Blessings,

Brady Bryce, *Director of Ministry Events*



Kate Miller (ministry events coordinator), Sandy Lowe (exhibit coordinator), Stephanie Lang (exhibit coordinator), and Brady Bryce (director).
Not pictured: Danielle Lough

8:30 A.M. CLASS OPTIONS

R&R OF MINISTRY AND MISSIONS

Rewards and Risks of Being in Ministry and Missions

8:30 a.m., Adams Center Faculty Commons, Classroom
Steve Allison (Abilene, Texas), Jeff Holland (Denison, Texas) 82201-01

These sessions examine two sides of ministry. First, ministers and missionaries experience joys and dangers. Second, we explore the rewards and stresses minister and missionary care providers experience. Part 1 of 2.

SEXY SACRIFICES: HAVE WE LAID OUR CHILDREN ON THE ALTAR OF COMMERCIAL CULTURE?

Media Influences on Girls' Identities

8:30 a.m., MBB 115
Jennifer Shewmaker (Abilene, Texas), Stephanie Talley (Abilene, Texas) 82201-02

Childrens' ideas concerning sex and sexuality develop gradually and are influenced by their environment. Are Christians comfortable with the images media and culture provide? How does our spiritual community protect our children and provide a healthy context to support parents in raising healthy children? Part 1 of 2.

STONE AND CAMPBELL WANDER THE GROVES OF ACADEME: RESTORATION PRINCIPLES AND UNIVERSITY EDUCATION

Examples from Other Traditions

8:30 a.m., MBB 117
Chris Willerton (Abilene, Texas) and ACU Students 82201-03

At a university connected with the American Restoration, how many students actually think about Stone and Campbell? How many professors? Can they explain how degree requirements, spring mission trips, and chapel programming might be connected to the Restoration heritage? A professor and student panelists explore whether the great convictions (and even the contradictory impulses) of the Stone-Campbell heritage can stimulate our church-related universities in the new century. Part 1 of 2.

NURTURING YOUR BODY TO FEED YOUR MIND AND SPIRIT

Being Happier and Healthier and Closer to God

8:30 a.m., BSB 103
Joe D. Bell (Abilene, Texas) 82201-04
Can your outlook on life affect your health or can your health affect your faith? This class explores the body-mind-spirit connection as it relates to our walk with God.

PUTTING EARS ON OUR HEARTS

A Prayer Retreat for Hearing God Within

8:30 a.m., BSB 104
Jacqueline King (Denton, Texas) 82201-05
This class explores using *lectio divina* (divine reading) as the foundation for a prayer retreat designed to learn to hear God from within. "Faith comes from hearing the message and the message is heard through the Word of Christ" (Romans 10:17).

TRANSCENDENT LEADERSHIP

The Daily Walk

8:30 a.m., BSB 112
Margaret J. Weber (Malibu, Calif.) 82201-06
Walking daily with God calls us to lead in multiple ways as we interact in the workplace, at home and with our spiritual family. How does transcendent leadership give us a way to look at our calling as God's people? Part 1 of 2.

IGLESIAS DE CRISTO

8:30 a.m., BSB 113
Jorge Daniel Garcia (Abilene, Texas), Patricia Hernandez (Abilene, Texas) 82201-07
A reflection on the current situation and culture of the Spanish-speaking Churches of Christ in the United States and Latin America. How can we serve each other as brother and sister? How can we enrich each others' lives? Part 1 of 2.

SECOND LIFE? WHAT HAPPENED TO MY FIRST ONE?

Cultural Trends of Youth: Predicting Issues on the Horizon

8:30 a.m., BSB 114
David W. Frazee (Fort Worth, Texas) 82201-08
If you have difficulty texting and driving, or you have no idea what "texting" is, this class is for you. This class explores the latest trends impacting today's teenagers and families and examines ministry strategies designed to equip adults and teens to navigate cultural waters together.

BSB – Onstead-Packer Biblical Studies Building MBB – Mabree Business Building WPA – Williams Performing Arts Center



Morning Prayers at Jacob's Dream

• 8 a.m. daily

A MISSIONAL RESPONSE TO SOCIAL JUSTICE AND POVERTY

8:30 a.m., BSB 115

Tanya Brice (Abilene, Texas), Darrell Jordan (Abilene, Texas) 82201-09

The church's efforts to ameliorate poverty and pursue social justice are often disconnected from its missional purpose. Do churches struggle to identify the authority to address social problems? We will discuss missional authority and private troubles. Part 1 of 3.

**KINGDOM LIFE REMIXED
Beyond the Church We've Known**

8:30 a.m., BSB 117

John White (Denver, Colo.) 82201-10

People across North America are exploring new/old ways of following Jesus. Sometimes called Emergent, New Monastic, Simple, Virtual or House Church, these expressions of Kingdom life hold exciting possibilities and significant challenges. Join a vibrant discussion with leading practitioner-coaches in this movement. Part 1 of 3.

CAMPUS EVANGELISM, CAMPUS REVIVAL AND SPIRITUAL AWAKENING

What Went Right? What Went Wrong?

8:30 a.m., BSB 120

Jim R. Bevis (Florence, Ala.) 82201-11

In the 1960s, campus evangelism was the most exciting and controversial movement among Churches of Christ. Led by Jim Bevis and Rex Vermillion, the short-lived ministry touched more than 40,000 students on some 400 campuses. Campus Evangelism "closed its doors" in 1970. Jim Bevis, co-founder of CE, shares his perspective of what happened. Part 1 of 3.

**RISEN FROM THE ASHES
Christian Women in the 21st Century:
With Bodies That Are Living Sacrifices**

8:30 a.m., BSB 122

Shirley D. Straker (Ontario, Canada) 82201-12

In Romans 12, Paul urged Roman Christians to present their bodies as living sacrifices and to be transformed by the renewing of their minds. How can Jesus' sisters in the 21st century meet these challenges? Part 1 of 2.

**ADOPTION: REAL-LIFE ADOPTION EXPERIENCES REMIND US WE ARE ALL GOD'S ADOPTED CHILDREN
God's Purpose is for Every Child to Be His Child**

8:30 a.m., BSB 126

Kelly Vaughn (Fort Worth, Texas) 82201-13

We are God's children, but do we act like it? One mother's experience with adoption reminds us of our true identity in Christ. Part 1 of 3.

**LET MY PEOPLE GO
Leaving the Church to Be the Church**

8:30 a.m., BSB 127

Bert Reynolds (Little Rock, Ark.) 82201-14

Every church desires to join more fully in God's mission. Unfortunately, some of the ways we do church can hamper our call to be the church. Join the conversation as we explore ways to turn our churches loose for ministry. Part 1 of 3.

**ROMANS' PROVERBIAL ROOTS
A Woman's Place is in the Creation: The Woman Not Seen but Heard (Romans 1:20 and Proverbs 8)**

8:30 a.m., BSB 128

Glenn Pemberton (Abilene, Texas) 82201-15

If your text is difficult, find some context for it to eat; if it is still ambiguous, give it some background to drink and heap burning coals upon the text. Our classes will explore Proverbs' contribution to understanding Romans. Part 1 of 2.

**COVENANT RIGHTEOUSNESS IN ROMANS
God Keeps His Covenant Promises**

8:30 a.m., BSB 129

Thomas H. Olbricht (South Berwick, Maine) 82201-16

Underlying Romans is a narrative of God's promise that He will bless all of humankind through the descendants of Abraham. God did right through the obedience of Jesus who calls humankind to the obedience of faith. Part 1 of 3.

**LEADERSHIP AND CHURCH GROWTH
Leadership and Its Impact on the Worship Service**

8:30 a.m., BSB 130

Ian Fair (Durango, Colo.) 82201-17

Explore the impact on leadership on the dynamic of decline and growth in the local congregation. Part 1 of 3.

**The World Famous Bean
(Monday-Friday)**

- Breakfast 7-9:30 a.m.
- Lunch: 11:30 a.m. - 2 p.m.
- Dinner 5-7 p.m.

Lunch at The Grill on the Hill

- BSB, Chapel on the Hill Portico
- 11:30 a.m. - 1:15 p.m.

FIVE THEOLOGICAL TURNINGS, PART 1

8:30 a.m., BSB 200 (Chapel on the Hill)
Brian D. McLaren (Laurel, Md.) 82201-18

This class for ACU graduate and undergraduate ministry students addresses five turnings of theology in a postmodern world. Brian will explore theology, atonement, eschatology, scripture, and God.

WILL THE REAL GOD PLEASE STAND UP? THE SEARCH FOR JUSTICE IN THE OLD TESTAMENT

God as Vindicator and Deliverer: Justice in the Pentateuch

8:30 a.m., BSB 100 (Hart Auditorium)
Mark Hamilton (Abilene, Texas) 82201-19

These lessons explore biblical resources for our pursuit of justice. While justice and love often are played against each other, in the Bible they are complementary features of God's redemptive work. Justice is more than punishment for sin. Justice is commitment to a reality in which all humans have enough power, status and wealth to function as human beings made in God's image. Part 1 of 3.

BORROWED CREATIVITY

The Artist's Calling to an Original Life

8:30 a.m., WPA, Fulks Theatre
Ginger Morby (Surprise, Ariz.) 82201-20

How often does the Christian culture merely resemble a subculture of the current trends in secular America? Perhaps it is not the trends that should alarm believers, but rather the lack of ingenuity displayed within "Christian" creative arts. The artist who professes Christ has a unique calling to originality, relevance and truth. Part 1 of 2.

9:45 A.M. CLASS OPTIONS

GROWING GLOBAL CHRISTIANS

Putting Missions in Bible School Curriculum

9:45 a.m., Adams Center Faculty Commons, Classroom
Joyce Hardin (Dripping Springs, Texas) 82202-01

Utilizing experimental methods and hands-on activities, this interactive class emphasizes the importance evangelism and missions in Bible school curriculum to encourage children in their role to practice the Great Commission.

CHRISTIAN ACTIVISM

It's About Tastes, Interests and Values

9:45 a.m., MBB 115
Floyd Rose (Valdosta, Ga.) 82202-02

We are driven by tastes, interests and values. Our Christian activism, or lack thereof, is determined by what we have a taste for, an interest in and what we value. These tastes, interests and values are determined by parental, social and religious environments. Part 1 of 2.

DISCIPLESHIP AND DISCIPLINE WITHIN THE ACADEMY

9:45 a.m., MBB 117
*B. Cole Bennett (Abilene, Texas),
 Tracy M. Shilcutt (Abilene, Texas)* 82202-03

These sessions explore connections between academic disciplines and "discipleship." Can we really walk the road between Athens and Jerusalem? Between history and literature? Between Bible and art? Answers to these questions affect approaches to learning in a liberal arts environment. Part 1 of 2.

NOTHING CAN SEPARATE US:

GOD'S LOVE FOR THE SAME-SEX STRUGGLER

A Christ-Centered Response to Same-Sex Attraction Beyond Romans 1

9:45 a.m., BSB 103
Sally Gary (Abilene, Texas) 82202-04

The Christian community is starved for answers to our questions about sexual orientation. In these sessions we will explore a more Christ-centered response to those who experience same-sex attraction – beginning with a better understanding of this struggle. Going beyond the first chapter of Romans, we'll reaffirm the truth that it is God's love that changes all of us. And we'll discover ways to take that life-changing truth to a world that is desperate for His love. Part 1 of 3.

MORE THAN DINNER AT OUR PLACE

The Reconciling Work of Living Hospitably

9:45 a.m., BSB 104
Charme Roberts (Dallas, Texas) 82202-05

How can Christians respond to a culture marked with scars of isolation? What are the practices and ways of being that lead away from shallow niceties and lead toward the generous landscape of reconciliation?

BSB – Onstead-Packer Biblical Studies Building MBB – Mabree Business Building WPA – Williams Performing Arts Center

iTunes U

- Selected classes and theme conversations will be available after the event by visiting ACU on iTunes U to download MP3 files
- www.acu.edu/itunessummit

LIVING, LOVING AND LEADING FROM THE HEART
Leadership Realities Facing Christian Women

9:45 a.m., BSB 112

Lee Ann Nutt (Denton, Texas) 82202-06

Responsible for educating more than 10,000 college students across three campuses, Nutt confronts the realities of being a Christian woman who is a college vice president ... and the realities of being a college vice president who is a Christian woman. Part 1 of 2.

THE MARRIAGE-FRIENDLY PLACE

9:45 a.m., BSB 113

Beverly Ross (Decatur, Texas) 82202-07

How can churches better protect and nurture marriage relationships? This session explores proactive ways to deal with marital crisis and tools that encourage safe boundaries and better connection within marriage.

STROKES FROM A BACKLIT KEYBOARD

Reading Romans in the Ambient Light of Youth Culture

9:45 a.m., BSB 114

Houston Heflin (Richardson, Texas) 82202-08

Paul's letter to the Roman church transcends its temporal and geographic context by speaking to the heart of adolescents in our culture. Romans confronts obstacles that have kept youth from faith and inspires commitment to Christian community.

GROWING OLD IN CHRIST: BLESSINGS AND CHALLENGES OF MINISTRY TO THE AGING

Are You As Old As You Feel? Social, Psychological and Theological Perspectives

9:45 a.m., BSB 115

Jack Holland (Johnson City, Tenn.) 82202-09

The changing demographics of the aging population, particularly the baby boomer generation create opportunity for ministry. These sessions consider aging from a theological and pastoral perspective in responding to these needs. Part 1 of 3.

KINGDOM LIFE REMIXED PANEL
The Conversation Continues ...

9:45 a.m., BSB 117

Facilitator: Kent Smith (Abilene, Texas)

Panelists: Jared Looney (Bronx, N.Y.),

John White (Denver, Colo.) 82202-10

Kent Smith will facilitate conversation with panelists and class attendees to follow up the 8:30 a.m. class session. Part 1 of 3.

WALKING WITH THE SPIRIT:
THE TRANSITIONS OF K.C. MOSER
Heritage: Moser's Texas Roots

9:45 a.m., BSB 120

Bobby Valentine (Tucson, Ariz.) 82202-11

Part 1 of 3.

WORSHIP FOR THE DEAF

9:45 a.m., BSB 122

Hollis Maynard (Lubbock, Texas) 82202-12

A discussion of the advantages of interpretive services for the deaf and separate deaf worship. Comparison of major deaf "churches" in the United States and abroad. Suggestions for improvement of worship leadership between hearing and deaf leaders. Discussion of methods for improving the spirituality of deaf members in the deaf church.

TABLE SCRAPS

The Art of Self-Denial

9:45 a.m., BSB 126

Geoffrey Broderick (Abilene, Texas) 82202-13

This visual PowerPoint presentation describes the art of iron casting, the soup bowls that will be cast at the casting event, and how donations for these bowls will feed the hungry.

OLIVE TREES AND CYBORGS

Christian Identity in Paul's Letter to the Romans

9:45 a.m., BSB 127

Jennifer J. Thweatt-Bates

(New York, N.Y.) 82202-14

These classes examine how Paul addresses the competing concepts of identity at work within the Jewish and Gentile Christians in Rome, and asks how Paul's vision of Christian identity applies to us today. Part 1 of 3.



CDs and DVDs

- During Lectureship, CDs and DVDs are available in Teague Special Events Center
- To order CDs after Lectureship from rePlay, call 325-674-3744 or order online at www.acureplay.org
- DVDs of theme lectures and featured guest presentations are available from IN-Focus Digital at www.infocusdv.com or 325-672-0715

HOW TO WIN THE WAR AGAINST DRUG ABUSE ... IN YOUR HOME

9:45 a.m., BSB 129
 Kinwood H. DeVore
 (San Francisco, Calif.) 82202-16

The U.S. Justice Department, Congress, and the CIA are convinced the war against drugs cannot be won by this nation. But some have been winning the war for the past 19 years. Learn how the Metropolitan Church of Christ and her ministry, the Metropolitan Fresh Start House, experience the miracle of broken lives made whole through the living Word of God. Part 1 of 3.

PULLING TOGETHER WITHOUT COMING APART: A PANEL ON ELDER-MINISTER RELATIONSHIPS Disagreeing Together

9:45 a.m., BSB, Room 130
 Dean Bryce (Stillwater, Okla.), Malcolm Coco (Abilene, Texas), Eddie Sharp (Abilene, Texas), Jay Spencer (Paris, Texas) 82202-17

In a tradition that takes pride in congregational autonomy and volunteer leaders, how do full-time ministers and part-time elders pull together to serve God? This panel of two elders and two ministers from four churches will discuss their real life stories of what does and does not work to develop a leadership relationship in Churches of Christ. Part 1 of 3.

FIVE THEOLOGICAL TURNINGS, PART 2

9:45 a.m., BSB 200 (Chapel on the Hill)
 Brian D. McLaren (Laurel, Md.) 82202-18

This class for ACU graduate and undergraduate ministry students addresses five turnings of theology in a postmodern world. Brian will explore theology, atonement, eschatology, scripture, and God.

GOD OF THE MARGINS The Church and the Rhetoric of Illegal Immigration

9:45 a.m., BSB 128
 Jessica Reese Goudeau (Austin, Texas) 82202-15

This class examines the way that Christians in the United States talk about illegal immigration – one of the most controversial topics in politics today – and how our language reflects our attitude toward some of our society's most marginalized people.

11 A.M. THEME CONVERSATION

GOD SHOWS NO FAVORITISM Romans 2:1-11

11 a.m., Moody Coliseum
 Worship: *Come As You Are*
 David Flear (Rochester Hills, Mich.) 82203-19

1:30 P.M. HIGHLIGHT CLASSES

WHAT'S "NEW" ABOUT THE "NEW ATHEISM"?

1:30 p.m., BSB 200 (Chapel on the Hill)
 Rubel Shelly (Rochester Hills, Mich.) 82204-01
 Recent publications by Harris, Dawson, Hitchens and others have generated excitement about a "new atheism." What has generated this aggressive move from unbelievers? Are there new arguments and insights being offered to effectively counter the claims of Christian theism?

LIFESTYLES OF THE RICH AND AMOS Why Rich Religion Gets It Wrong

1:30 p.m., BSB 100 (Hart Auditorium)
 Rick Atchley (Fort Worth, Texas) 82204-02
 Most Christians say they reject "health and wealth" theology. Most Christians seem to want more than anything to be healthy and wealthy. Amos has something to say to most Christians. Part 1 of 3.

RELATIONSHIP 101: EIGHT THINGS EVERY LOVER NEEDS TO SAY The Indispensable Eight Secret Phrases!

1:30 p.m., Teague Special Events Center
 Jeff Walling (Charlotte, N.C.) 82204-03
 Come discover the amazing power in the ancient wisdom of the world's greatest lover-as he gives us a pattern for living in dynamic community. Part 1 of 3.

3 P.M. FEATURED GUEST

REACHING CHRISTIANS FOR CHRIST

3 p.m., Moody Coliseum
 Brian D. McLaren (Laurel, Md.) 82205-01

BSB – Onstead-Packer Biblical Studies Building MBB – Mabree Business Building WPA – Williams Performing Arts Center

Coffee House with Larry Mudd

- "Untouchable: Paul's Journey from Hitman to Apostle"
- Monday, 8:30 p.m., Brown Library, Learning Commons

Exhibits

- Visit booths in Teague Special Events Center sponsored by a variety of vendors, or purchase Lectureship CDs and DVDs
- For more information or to register online www.acu.edu/lectureship

4 P.M. CLASS OPTIONS

CHILDREN OF HELL OR CHILDREN OF HEAVEN?

Capturing the Heart

4 p.m., Adams Center Faculty Commons, Classroom
Sonny Guild (Abilene, Texas) 82206-01
History is replete with examples of well-meaning Christians doing more damage than good. Jesus accused Jewish evangelists of making their converts children of hell (Matthew 23:15). How do we, with the Lord's help, keep from making the same mistake? Part 1 of 2.

THE JUSTICE IMPERATIVE

The Rhetoric of the Letter to the Romans

4 p.m., MBB 115
Robert L. Foster (Dallas, Texas) 82206-02
Romans does more than oppose grace and law or protect Gentile converts from adopting traditional identity markers of Judaism. Romans is to call the Jesus community in Rome to practice the justice they see in God's work in Christ Jesus. Part 1 of 2.

WE ARE WHAT WE THINK!

But Are Our Children What We Think?

4 p.m., MBB 117
Becky Holton (York, Neb.) 82206-03
We are at war and the battlefield is our minds! These lessons examine the effects of our thinking on how we live and interact. Special focus will be given to the significant influence of parental thinking and moral reasoning on eventual child behaviors. Practical suggestions from Scripture are offered for jumping tracks to more Christ-like thinking and functioning. Part 1 of 2.

COMMUNICATION – THE FOUNDATION OF EFFECTIVE LEADERSHIP

4 p.m., Elements of Leadership Communication
Taylor A. McKenzie (San Diego, Calif.) 82206-04
BSB, Room 103
What constitutes effective leadership? Are charisma, likeability and longevity of church membership sufficient for effective leadership? Effective leadership and effective communication are inseparable. What is said and how it is said are major characteristics of leadership and group progress. Part 1 of 2.

WOMEN'S VIOLENCE IN GLOBAL POLITICS

The Narratives of Women's Violence

4 p.m., BSB 112
Caron E. Gentry (Abilene, Texas) 82206-05
These sessions introduce Gentry's book (with L. Sjoberg), *Mothers, Monsters, Whores* (2007), a critique of how politically violent women are portrayed. These portrayals remove agency from women and Christians need to explore how this perpetuates injustice. Part 1 of 2.

WHAT LANGUAGE MAY I BORROW?

A Theology for Praising God

4 p.m., BSB 113
Ron Highfield (Agoura Hills, Calif.) 82206-06
Has the church forgotten how to praise God? Has it narrowed its language of praise to a few time-worn phrases? God possesses many glorious qualities and has worked many wonderful deeds for which we never praise Him. Come and enrich your language of praise.

INSIDE THE YOUTH MINISTER'S STUDIO WITH BRIAN McLAREN

4 p.m., BSB 114
Robert Oglesby Jr. (Abilene, Texas) 82206-07
This dialog session provides Youth Ministers and Youth Ministry students an opportunity to interact with Brian McLaren.

FIGHTING FOR JUSTICE

The Role of the Church in the 21st Century

4 p.m., BSB 115
Brandon James Smith (Overland Park, Kan.) 82206-08
The church must find its new role in the 21st century. Once considered heralds of justice, the church must rediscover its call to fight for justice. With a world crying out for rescue, the church must once again enter the fight for justice.

HOW VISUAL MEDIA SAVED MY LIFE

How Media Will Help You Communicate

4 p.m., BSB 117
Rob Thomas (Dallas, Texas) 82206-09
Understanding the power of media and how to best use it to communicate God's ultimate story. We'll talk through how God's story influences movies and overall storytelling, and we'll also talk about ideas for how to use media in the 21st century.

Shuttle Service

- Free for all Lectureship guests from 7 a.m. to 10 p.m. daily
- Pick up and drop off locations are at Hillcrest Church of Christ, Moody Coliseum, Onstead-Packer Biblical Studies Building, University Church of Christ, and Williams Performing Arts Center
- Call 325-674-3744 to arrange transportation

SPIRITUAL CPR FOR A DYING GENERATION
A Post-modern Ministry for a Post-modern World

4 p.m., BSB 127
Dan Cooke (Denton, Texas) 82206-11

Every year churches are connecting less to university students, but that doesn't have to be the case. In this class, we will explore why the faith of college students seems to be dying and what can be done to revive it and make it flourish.

WHEN PEACE BREAKS OUT
A Righteous God Extends His Hand

4 p.m., BSB 128
Joey Cope (Abilene, Texas) 82206-12

Got conflict? Paul escorts you to the front row to witness and participate in God's outbreak of peace. Allow God's righteousness to guide your discovery of your birthright as peacemaker. Part 1 of 3.

EMERGING ELDERS
Do We Really Need Elders?

4 p.m., BSB 129
Ron Clark (Portland, Ore.) 82206-13

We in the Restoration Movement are unique. We have a model of leadership that involves ministers/evangelists and elders/pastors. We train ministers but unfortunately have not intentionally developed elders for the church in a post-Christian culture. However, elders emerge in an intentional development ministry. Part 1 of 3.

TRANSCENDING RACISM
Understanding and Resisting White Privilege

4 p.m., BSB 130
Douglas A. Foster (Abilene, Texas) 82206-14

White Christians are often unaware of the ways the social systems in the United States favor "white" ways of doing things. This class is an introduction to the ways white privilege hinders true racial unity in Christ.

CONQUEST: FINDING YOUR PLACE IN GOD'S MISSION
Moving from Maintenance to Mission

4 p.m., BSB 200 (Chapel on the Hill)
Scott Sager (Dallas, Texas) 82206-15

Are you ready to move your life from "maintenance" to "mission"? Is your church longing to shift from boredom to battle and from conflict to conquest? In an age filled with bored Christians and conflict-ridden congregations, the book of Joshua gives us a prescription on how to move from maintenance to mission and discover what a "missional church" is all about. Part 1 of 3.

SHOW US HOW YOU DO IT
Marshall Keeble and the Rise of the Black Churches of Christ in the United States

4 p.m., BSB 120
Edward J. Robinson (Abilene, Texas) 82206-10

Marshall Keeble (1878-1968) was without question the most influential black preacher in Churches of Christ. But he did not accomplish his great work alone. Keeble had white financial and black spiritual supporters who assisted him in his evangelistic endeavors. This class seeks to tell this complex and compelling story.

7 P.M. THEME CONVERSATION

GOD'S RIGHTEOUSNESS FOR SINNERS
Romans 3:21-26

7 p.m., Moody Coliseum
 Worship Leader: *Ryan Porche (Dallas, Texas)*
J. Kevin Murray (Compton, Calif.) 82207-01

8:30 P.M. LATE NIGHT EVENTS

EMPTY BOWLS: ART AND SOUP FOR THE HUNGRY
Iron Pour Event

8:30 p.m., The grassy area west of Teague Special Events Center
Faculty and students from ACU Art and Design Department

UNTOUCHABLE: PAUL'S JOURNEY FROM HITMAN TO APOSTLE

8:30 p.m. Performance, Brown Library, Learning Commons
Larry Mudd (New York, N.Y.) 82208-01

BSB – Onstead-Packer Biblical Studies Building MBB – Mabee Business Building WPA – Williams Performing Arts Center

Listen to all theme conversations live!

• www.acappellaradio.net

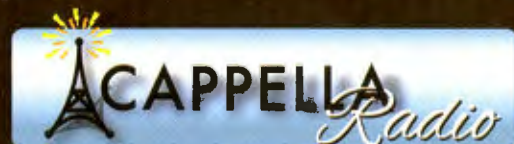

8:30 A.M. CLASS OPTIONS

R&R OF MINISTRY AND MISSIONS

Rewards and Risks of Being a Caregiver for Ministers and Missionaries

8:30 a.m., Adams Center Faculty Commons, Classroom
Steve Allison (Abilene, Texas), Jeff Holland (Denison, Texas) 82301-01
Part 2 of 2.

NO PASSPORT NEEDED

Moving Beyond Service to Social Justice

8:30 a.m., Brown Library, Mabee Library Auditorium
Casey McCollum (Richardson, Texas), Steve Sargent (Houston, Texas) 82301-02
What exactly are we teaching our students through mission trips? Do they return from Mexico with more than just Montezuma's Revenge? And, most important, are we missing the call of the Gospel and the mandate for social justice in our own backyard?

SEXY SACRIFICES: HAVE WE LAID OUR CHILDREN ON THE ALTAR OF COMMERCIAL CULTURE?

Nurturing a Godly Identity in Girls

8:30 a.m., MBB 115
Jennifer Shewmaker (Abilene, Texas), Stephanie Talley (Abilene, Texas) 82301-03
Part 2 of 2.

STONE AND CAMPBELL WANDER THE GROVES OF ACADEME: RESTORATION PRINCIPLES AND UNIVERSITY EDUCATION

The Great Question, "Why Bother?"

8:30 a.m., MBB 117
Chris Willerton (Abilene, Texas) and ACU Students 82301-04
Part 2 of 2.

ALREADY BUT NOT YET

Living in the Overlap

8:30 a.m., BSB 103
Edward Fudge (Houston, Texas) 82301-05
When Jesus ascended to God's right hand in fulfillment of Psalms 110:1, the age to come broke into the present age. This overlap of "already" and "not yet" pulls us in two different directions and is the time of spiritual gifts.

WHO ARE THESE PEOPLE? LABORERS ALONGSIDE THE LOCAL CHURCH

The Opportunities and Benefits of Para-church Organizations

8:30 a.m., BSB 104
Linda A. King (Edmond, Okla.) 82301-06
Like Texas bluebonnets in April, nonprofit, para-church organizations are springing up everywhere, inviting local Christian congregations to sponsor, participate in their specialized ministries and finance them. Join us as we examine the benefits and challenges of those who "labor alongside." Part 1 of 2.

TRANSCENDENT LEADERSHIP

We Are Called

8:30 a.m., BSB 112
Margaret J. Weber (Malibu, Calif.) 82301-07
Part 2 of 2.

CONFORMED TO THE IMAGE OF HIS SON

Life Transformation, Sunday Bible Classes, and Paul's Letter to the Romans

8:30 a.m., BSB 113
Steven Carrizal (Denton, Texas) 82301-08
Life transformation is too much to expect from a 45-minute Sunday morning Bible class ... or is it? Reading and studying Scripture in community should be more than an exercise in appreciating theology or passing on information. In this hour discover practical ideas for training teachers and creating a class environment that invites God's work of conforming us to the image of the Son.

A DIALOGUE WITH THE CHRISTIAN CHRONICLE

8:30 a.m., BSB 114
Lynn A. McMillon (Oklahoma City, Okla.) 82301-09
An opportunity to meet with the editor and other staff members of the *Christian Chronicle* to provide input and ask questions regarding coverage.

A MISSIONAL RESPONSE TO SOCIAL JUSTICE AND POVERTY

8:30 a.m., BSB 115
Tanya Brice (Abilene, Texas), Darrell Jordan (Abilene, Texas) 82301-10
Part 2 of 3.

TUESDAY

September 20



Men's Fellowship Dinner

- University Church of Christ, Ministry Activity Center (733 E.N. 16th St.)
- Speaker: Lynn McMillon
- Tickets: \$7 purchase at registration in Teague or at the door
- Contact: Ministry Events, 325-674-3750 or ministryevents@acu.edu

**KINGDOM LIFE REMIXED
Networking Simplicity**

8:30 a.m., BSB 117
John White (Denver, Colo.) 82301-11
 Part 2 of 3.

**CAMPUS EVANGELISM, CAMPUS REVIVAL
AND SPIRITUAL AWAKENING**

What on Earth is God Doing on the Campus Today?

8:30 a.m., BSB 120
Jim R. Bevis (Florence, Ala.) 82301-12
 Part 2 of 3.

RISEN FROM THE ASHES

**Christian Women in the 21st Century:
With Minds That Are Being Transformed**

8:30 a.m., BSB 122
Shirley D. Straker (Ontario, Canada) 82301-13
 Part 2 of 2.

**ADOPTION: REAL-LIFE ADOPTION EXPERIENCES
REMINDE US WE ARE ALL GOD'S ADOPTED CHILDREN**

With the Power of God's Adoption, We Are Conquerors

8:30 a.m., BSB 126
Kelly Vaughn (Fort Worth, Texas) 82301-14
 Part 2 of 3.

LET MY PEOPLE GO

**Humbly Joining Jesus in the Reconciliation
of All Things**

8:30 a.m., BSB 127
Bert Reynolds (Little Rock, Ark.) 82301-15
 Part 2 of 3.

ROMANS' PROVERBIAL ROOTS

**Come On, Baby, Light My Fire: Heaping Burning Coals
of Fire (Romans 12:20 and Proverbs 25:21-22)**

8:30 a.m., BSB 128
Glenn Pemberton (Abilene, Texas) 82301-16
 Part 2 of 2.

COVENANT RIGHTEOUSNESS IN ROMANS

The Narrative of God's Right Decisions

8:30 a.m., BSB 129
Thomas H. Olbricht (South Berwick, Maine) 82301-17
 Part 2 of 2.

**LEADERSHIP AND CHURCH GROWTH
The Leadership Factor: The Dynamic of
Effective Leadership**

8:30 a.m., BSB 130
Ian Fair (Durango, Colo.) 82301-18
 Part 2 of 3.

**WILL THE REAL GOD PLEASE STAND UP?
THE SEARCH FOR JUSTICE IN THE OLD TESTAMENT
When Righteousness and Peace Kiss:
Justice in Israel's Worship Texts**

8:30 a.m., BSB 100 (Hart Auditorium)
Mark Hamilton (Abilene, Texas) 82301-19
 Part 2 of 3.

**MATTHEW SLEETH'S DIALOGUE
WITH ECOLOGY STUDENTS**

8:30 a.m., BSB 200 (Chapel on the Hill)
Matthew Sleeth (Wilmore, Ky.) 82302-19

9:45 A.M. CLASS OPTIONS

**HOW LONG CAN YOU TREAD WATER?
Sacrificial Help for Tsunami Victims**

9:45 a.m., Adams Center Faculty Commons, Classroom
Larry Henderson (Abilene, Texas) 82302-01
 How did Christians respond to the 2004 tsunami in Asia?
 What doors of opportunities have opened as a result?
 What pitfalls have emerged that might help shape future
 relief efforts? Hear some of the stories of faith from people
 on the scene. Part 1 of 2.

**REFLECTIONS ON YOUTH MINISTRY
A Special Session Designed for Youth Ministers and
Youth Ministry Students**

9:45 a.m., Brown Library, Mabee Library Auditorium
Facilitator: Robert Oglesby Jr. (Abilene, Texas) 82302-02
 A panel will reflect on what keeps them in ministry and the
 moments that made them want to quit.

**A LAW UNTO THEMSELVES
Spiritual Lessons from Contemporary Art**

9:45 a.m., BSB 113
Kenny Jones (Abilene, Texas) 82302-08
 When nonbelievers confirm spiritual truths how should we
 respond? If God's righteousness places us all on equal

BSB – Onstead-Packer Biblical Studies Building MBB – Mabee Business Building WPA – Williams Performing Arts Center



Campus Tours

• Meet at 1:05 p.m. daily at *Jacob's Dream*

footing then even secular artists may have a reluctant spiritual message. Explore the outrageous aesthetic as it appears in scripture and museums.

CHRISTIAN ACTIVISM

It's About Where We Were When

9:45 a.m., MBB 115

Floyd Rose (Valdosta, Ga.) 82302-03

Part 2 of 2.

DISCIPLESHIP AND DISCIPLINE WITHIN THE ACADEMY

9:45 a.m., MBB 117

B. Cole Bennett (Abilene, Texas), Tracy M. Shilcutt (Abilene, Texas) 82302-04

Part 2 of 2.

NOTHING CAN SEPARATE US: GOD'S LOVE FOR THE SAME-SEX STRUGGLER Changing Hearts by God's Love

9:45 a.m., BSB 103

Sally Gary (Abilene, Texas) 82302-05

Part 2 of 3.

CHRISTIAN FINANCES – AN OXYMORON?

9:45 a.m., BSB 104

Scott K. Stegall (Denton, Texas) 82302-06

Are Christians identifiable by our financial dealings?
Does God care about my personal financial discipline?
Or my church's finances? A short discussion on biblical financial principles.

CONTENT FOR BIBLE CLASSES FOR THE DEAF

9:45 a.m., BSB 122

Larry Prince (Abilene, Texas) 82302-13

Sources for Bible lessons for the deaf. Utilization of visual technology and suggestions for the use of it in teaching the deaf.

MISSIONARY CARE

Caring for the Beautiful Feet That Bring Good News

9:45 a.m., BSB 126

Dorris M. Schulz (North Richland Hills, Texas) 82302-14

How the local church can meet the needs of missionaries at every stage of his or her career cycle.

LIVING, LOVING AND LEADING FROM THE HEART Leadership Realities Facing Christian Women

9:45 a.m., BSB 112

Lee Ann Nutt (Denton, Texas) 82302-07

Part 2 of 2.

AT WORK IN THE FIELDS OF THE LORD: BEING A CHAPLAIN TO A SECULAR UNIVERSITY What Is a Nice Chaplain Like You Doing in a Place Like This?

9:45 a.m., BSB 114

Robert M. Randolph (Cambridge, Mass.) 82302-09

Randolph is the first chaplain to the institute at MIT. This class will discuss why the institute made the decision to have a chaplain and the theology of presence that undergirds the role of chaplain in a secular university. Part 1 of 2.

GROWING OLD IN CHRIST: BLESSINGS AND CHALLENGES OF MINISTRY TO THE AGING Over the Hill and Up Again: Aging as Countercultural Living

9:45 a.m., BSB 115

Jack Holland (Johnson City, Tenn.) 82302-10

Part 2 of 3.

KINGDOM LIFE REMIXED PANEL The Conversation Continues ...

9:45 a.m., BSB 117

Facilitator: Kent Smith (Abilene, Texas)

Panelists: Jared Looney (Bronx, N.Y.),

John White (Denver, Colo.) 82202-10

Part 2 of 3.

WALKING WITH THE SPIRIT: THE TRANSITIONS OF K.C. MOSER Awakening: Moser's Spiritual Crises

9:45 a.m., BSB 120

Bobby Valentine (Tucson, Ariz.) 82302-12

Part 2 of 2.

OLIVE TREES AND CYBORGS The Source of Christian Identity in Paul's Letter to the Romans

9:45 a.m., BSB 127

Jennifer J. Thweatt-Bates (New York, N.Y.) 82302-15

Part 2 of 3.

TUESDAY

September 23



Women for ACU Dinner

- WPA, Lobby
- Speaker: Linda Egle
- Tickets: \$12
- Contact: Samantha Adkins, 325-674-2622 or wacu@acu.edu

**TENACIOUS HOSPITALITY:
WELCOMING THE UNWELCOMED**

Sad People Are Just No Fun! Include Them Anyway

9:45 a.m., BSB 128

*MaLesa Breeding (Abilene, Texas),
Dana Hood (Abilene, Texas) 82302-16*

Families of children with disabilities are often "unwelcomed." Their stories challenge the church to examine the call to hospitality that includes rejoicing, mourning and those of low position. They teach us to be "patient in affliction" as we welcome all in Jesus' name. Part 1 of 2.

**HOW TO WIN THE WAR AGAINST DRUG ABUSE ...
In the Church**

9:45 a.m., BSB 129

Kinwood H. DeVore (San Francisco, Calif.) 82302-17

Part 2 of 3.

**PULLING TOGETHER WITHOUT COMING APART:
A PANEL ON ELDER-MINISTER RELATIONSHIPS
Serving Together with Deacons and Ministry Leaders**

9:45 a.m., BSB 130

*Dean Bryce (Stillwater, Okla.), Malcolm Coco (Abilene, Texas),
Eddie Sharp (Abilene, Texas), Jay Spencer (Paris, Texas) 82302-18*

Part 2 of 3.

**"BUT I WAS JUST PREACHING!" PROCLAIMING
JUSTICE AND HOPE FROM THE OLD TESTAMENT
"I Don't Like the Way This Story Ends" Justice as a Goal
of Narrative Preaching**

9:45 a.m., BSB 100 (Hart Auditorium)

*Mark Hamilton (Abilene, Texas), Stephen Johnson (Abilene, Texas),
Tim Sensing (Abilene, Texas) 82302-20*

This workshop helps participants think about preaching Old Testament texts concerning justice. Each session addresses a genre of biblical text and panelists discuss the move from text to sermon. Since biblical texts often conceive of justice as reciprocal, generous, mutually beneficial relationships, preaching can help us move beyond guilt to true community. Part 1 of 2.

**BORROWED CREATIVITY
Prizing the Message While Changing in the Methods**

9:45 a.m., WPA, Fulks Theatre

Ginger Morby (Surprise, Ariz.) 82302-21

Part 2 of 2.

11 A.M. THEME CONVERSATION

**SIN CONDEMNED IN CHRIST JESUS
Romans 8:1-11**

11 a.m., Moody Coliseum

Worship: *Come As You Are*

James Thompson (Abilene, Texas) 82303-01

1:30 P.M. HIGHLIGHT CLASSES

WHY BELIEVING IS SEEING

1:30 p.m., BSB 200 (Chapel on the Hill)

Rubel Shelly (Rochester Hills, Mich.) 82304-01

How should we understand the nature of faith? How can we make the claim that Jesus is "God with us" in a postmodern culture? This presentation makes a positive case for basic Christian affirmations that are central to orthodox faith.

**LIFESTYLES OF THE RICH AND AMOS
Why Rich Religion Gets It Right**

1:30 p.m., BSB 100 (Hart Auditorium)

Rick Atchley (Fort Worth, Texas) 82304-02

Part 2 of 3.

**RELATIONSHIP 101: EIGHT THINGS
EVERY LOVER NEEDS TO SAY
Emptying Your Heart So God Can Fill It**

1:30 p.m., Teague Special Events Center

Jeff Walling (Charlotte, N.C.) 82304-03

Part 2 of 3.

3 P.M. FEATURED GUEST

**SERVE GOD, SAVE THE PLANET
A Christian Call to Action**

3 p.m., Moody Coliseum

J. Matthew Sleeth (Wilmore, Ky.) 82305-01

BSB – Onstead-Packer Biblical Studies Building MBB – Mabree Business Building WPA – Williams Performing Arts Center

Coffee House with Shelly Sanders and ACU students

"The Golden Compass": Responding to the Book Where They Kill God

• Tuesday, 8:30 p.m. Brown Library Learning Commons

4 P.M. CLASS OPTIONS

CHILDREN OF HELL OR CHILDREN OF HEAVEN?

Capturing the Mind

4 p.m., Adams Center Faculty Commons, Classroom
Sonny Guild (Abilene, Texas) 82306-01
Part 2 of 2.

THE JUSTICE IMPERATIVE

The Justice of God and the Just Community in Romans

4 p.m., MBB 115
Robert L. Foster (Dallas, Texas) 82306-02
Part 2 of 2.

WE ARE WHAT WE THINK!

How Do I Jump Tracks and Get to a Different Train of Thought?

4 p.m., MBB 117
Becky Holton (York, Neb.) 82306-03
Part 2 of 2.

COMMUNICATION – THE FOUNDATION OF EFFECTIVE LEADERSHIP

A Leader's Communicative Approach to Conflict

4 p.m., BSB 103
Taylor A. McKenzie (San Diego, Calif.) 82306-04
Part 2 of 2.

WOULD THE APOSTLE PAUL USE THE INTERNET?

MISSIONS IN A WIRED WORLD

Exciting Opportunities in Missions Through Videoconferencing

4 p.m., BSB 104
Steve Austin (Abilene, Texas) 82306-05

Would you like live, continuous contact with your missionaries and their work? Could you stretch your missions budget dollar? Find out how your missions program can expand, become more personal and more immediate. Part 1 of 2.

THE GOD-PRAISING AND EARTH-CARING COMMUNITY Why Should the Church Care About the Planet Anyway?

4 p.m., BSB 112
Eric Yates (Little Rock, Ark.) 82306-06
Have you noticed that "going green" seems to be the trendy thing to do these days? Does the church have a voice when it comes to caring for the planet? Should we say or do anything? Part 1 of 2.

NEW HYMNS, OLD PROBLEMS

And You Think Music Troubles Are New!

4 p.m., BSB 113
Jack Boyd (Abilene, Texas) 82306-07
Religious music touches on two explosive areas: 1) memories of music learned in our youth and 2) religious change. Throughout the 2,000 years of Christianity, change has always caused problems and music was often at the top of the hit list. Part 1 of 2.

AT WORK IN THE FIELDS OF THE LORD:

BEING A CHAPLAIN TO A SECULAR UNIVERSITY

A Theology of Presence

4 p.m., BSB 114
Robert M. Randolph (Cambridge, Mass.) 82306-08
Part 2 of 2.

THE VIOLENCE OF LOVE

What It Means to Be a Better Lover in Light of a Not-So-Loving World

4 p.m., BSB 115
Matthew Ryan Worthington (San Antonio, Texas) 82306-09

"If you love only those who love you, why should you get credit for that ... love your enemies! Do good to them." What do Jesus' words from Luke 6 mean in a world where so much anger, terrorism, corruption, judgment and brutality pervade our televisions, newspapers, politics and even our churches. How will we choose to be different in this world? What are the consequences of such a choice?

TUESDAY

September 23



The Bible and the Artists of the 20th Century

Gallery Talk and Tour sponsored by ACU Art and Design Department

- Don H. Morris Center, Shore Art Gallery
- Speaker: Garlan Jenkins
- Contact: Garlan Jenkins, gjf07a@acu.edu

REDEFINING CHRISTIANISM
Comforting the Disturbed

4 p.m., BSB 117
 Matt Wallace (Denver, Colo.), Nikki Wallace (Denver, Colo.) 82306-10

Come be challenged and encouraged by stories of ministry among homeless youth from the Dry Bones ministry in Denver, Colo. Hear how the disturbed have begun to find comfort, the comfortable have been shaken from their comfort and everyone's faith has been forever changed. A new Christianity is alive on the streets of Denver. Part 1 of 2.

THREE DECISIVE DATES FOR CHURCHES OF CHRIST
The Pivotal Events of 1809, 1909 and 2009

4 p.m., BSB 120
 Douglas A. Foster (Abilene, Texas) 82306-11

The bicentennial of Thomas Campbell's "Declaration and Address" and the anniversary of the "Centennial Convention" in Pittsburgh in 1909 provide the background for powerful new calls for unity in events planned for 2009.

MULTICULTURALISM AND DIVERSITY: THE 21ST CENTURY CHALLENGES FOR THE CHURCH
Is the Gospel Relevant to My Culture?

4 p.m., BSB 127
 George Pendergrass (Abilene, Texas) 82306-12

This class discusses some of the greatest challenges facing the church in the 21st century and what it takes to make the greatest impact on our communities and churches. Part 1 of 2.

WHEN PEACE BREAKS OUT
A Righteous God Invites Reverence

4 p.m., BSB 128
 Joey Cope (Abilene, Texas) 82306-13
 Part 2 of 3.

EMERGING ELDERS
Family Elders Shepherding Today's Families

4 p.m., BSB 129
 Ron Clark (Portland, Ore.) 82306-14
 Part 2 of 3.

MOVING BEYOND WHITE JESUS
An Introduction to Black Theology

4 p.m., BSB 130
 Travis Stanley (Irving, Texas),
 Walter L. Taylor (Lewisville, Texas) 82306-15

For centuries, the western church pictured Jesus as white. In order to transcend racism, Christians must learn to see Jesus through another's eyes. This class explores themes from black theology, offering another picture of Jesus that will energize contemporary efforts at racial reconciliation.

CONQUEST: FINDING YOUR PLACE IN GOD'S MISSION
Stepping Out into Deep Waters

4 p.m., BSB 200 (Chapel on the Hill)
 Scott Sager (Dallas, Texas) 82306-16
 Part 2 of 3.

7 P.M. THEME CONVERSATION

FROM GOD, THROUGH GOD AND TO GOD
ARE ALL THINGS
Romans 11:25-36

7 p.m., Moody Coliseum
 Worship Leader: D.J. Bulls (Arlington, Texas)
 Randy Harris (Abilene, Texas) 82307-01

8:30 P.M. LATE-NIGHT EVENTS

MUSICA ROMANA
Fifteen Centuries of Roman Music

8:30 p.m., WPAC, Recital Hall
 ACU Music Department Faculty

THE GOLDEN COMPASS: RESPONDING TO
THE BOOK WHERE THEY KILL GOD

8:30 p.m., Brown Library, Learning Commons
 Shelly Sanders (Abilene, Texas)
 with ACU Students 82308-01

BSB – Onstead-Packer Biblical Studies Building MBB – Mabee Business Building WPA – Williams Performing Arts Center

Women for ACU Pie Sale

- Teague Special Events Center
- Sunday 8-10 p.m.
- Monday-Wednesday
 12:30-4 p.m. and 8:30-10 p.m.

Listen to theme conversations live!



www.acappellaradio.net

8:30 A.M. CLASS OPTIONS

ALREADY BUT NOT YET

Spiritual Gifts, Until ...

8:30 a.m., BSB 103

Edward Fudge (Houston, Texas) 82401-01

Part 2 of 2.

WHO ARE THESE PEOPLE?

LABORERS ALONGSIDE THE LOCAL CHURCH

Matters of Law, Matters of Polity:

The Challenge of Para-church Organizations

8:30 a.m., BSB 104

Linda A. King (Edmond, Okla.) 82401-02

Part 2 of 2.

ONE CHURCH'S METHOD FOR EMBRACING

NEW MEMBERS

8:30 a.m., BSB 112

Doug Brown (San Antonio, Texas) 82401-03

Belonging to a group is vital for us and critical to church vitality. But too often, new people are challenged by our churches and our groups. How can we connect effectively?

MY BROTHER Y MI HERMANO

8:30 a.m., BSB 113

Jorge Daniel Garcia (Abilene, Texas), Patricia Hernandez (Abilene, Texas) 82401-04

Part 2 of 2.

CONFESS AND BELIEVE JESUS CHRIST

IS THE LORD (ROMANS 10:9)

Persecution and Faith in China

8:30 a.m., BSB 114

Bob Fu (Midland, Texas) 82401-05

What does Paul mean when he writes, "if you confess with your mouth that 'Jesus Christ is the Lord' and you believe in your heart that God raised Him from the dead, you will be saved"? Church history reveals that the blood of the martyrs is the seed for the church's growth. While the history of the Chinese church is one of persecution, it also is also a history of vibrant revival, mission movements, and house churches.

Part 1 of 3.

A MISSIONAL RESPONSE TO SOCIAL JUSTICE AND POVERTY

8:30 a.m., BSB 115

Tanya Brice (Abilene, Texas),

Darrell Jordan (Abilene, Texas) 82401-06

Part 3 of 3.

KINGDOM LIFE REMIXED

Re-envisioning Kingdom Leadership

8:30 a.m., BSB 117

John White (Denver, Colo.) 82401-07

Part 3 of 3.

CAMPUS EVANGELISM, CAMPUS REVIVAL AND SPIRITUAL AWAKENING

Mobilizing Campus Ministries for Maximum Impact

8:30 a.m., BSB 120

Jim R. Bevis (Florence, Ala.) 82401-08

Part 3 of 3.

ADOPTION: REAL-LIFE ADOPTION EXPERIENCES REMIND US THAT WE ARE ALL GOD'S ADOPTED CHILDREN

Do You Believe God is Your Adoptive Father?

8:30 a.m., BSB 126

Kelly Vaughn (Fort Worth, Texas) 82401-09

Part 3 of 3.

LET MY PEOPLE GO

A Little Less Conversation, a Little More Action

8:30 a.m., BSB 127

Bert Reynolds (Little Rock, Ark.) 82401-10

Part 3 of 3.

FRESH FACE ON THE ANCIENT TALE

Crafting Narrative Sermons They Won't Ever Forget

8:30 a.m., BSB 128

Larry Mudd (New York, N.Y.) 82401-11

Make Scripture come alive. Preaching the primary character in a biblical passage (i.e. Paul) has tremendous impact and fosters lasting personal application. Culture and creativity combined with dramatic storytelling and exegesis yield teaching tools for beginners to veterans.

WEDNESDAY

September 24

Graduate School of Theology Alumni Luncheon

- WPA, Lobby
- Speaker: Jennifer Nicholson
- Tickets: Complimentary, pick up from College of Biblical Studies, Dean's Office
- Contact: Sandy Lowe, 325-674-3700 or lowe@bible.acu.edu

COVENANT RIGHTEOUSNESS IN ROMANS

Obedience: Jesus Doing Right, Humankind Doing Right

8:30 a.m., BSB 129

Thomas H. Olbricht (South Berwick, Maine) 82401-12

Part 3 of 3.

LEADERSHIP AND CHURCH GROWTH

Developing Effective Leadership in the Context of Church Growth

8:30 a.m., BSB 130

Ian Fair (Durango, Colo.) 82401-13

Part 3 of 3.

DECEPTION

8:30 a.m., BSB 200 (Chapel on the Hill)

Sam Solomon 82401-14

**WILL THE REAL GOD PLEASE STAND UP?
THE SEARCH FOR JUSTICE IN THE OLD TESTAMENT**

**Seeking an Everlasting Peace:
Justice in the Prophets of Israel**

8:30 a.m., BSB 100 (Hart Auditorium)

Mark Hamilton (Abilene, Texas) 82401-15

Part 3 of 3.

9:45 A.M. CLASS OPTIONS

HOW LONG CAN YOU TREAD WATER?

Long-term Challenges of Tsunami Aid

9:45 a.m., Adams Center Faculty Commons, Classroom

Larry Henderson (Abilene, Texas) 82402-01

Part 2 of 2.

**NOTHING CAN SEPARATE US:
GOD'S LOVE FOR THE SAME-SEX STRUGGLER**

Changing Minds

9:45 a.m., BSB 103

Sally Gary (Abilene, Texas) 82402-02

Part 3 of 3.

OCULUS DEI

Photography as Ministry

9:45 a.m., BSB 104

Greg Kendall-Ball (Abilene, Texas) 82402-03

In the "body of Christ," who are the eyes? See and hear how one photographer is trying to use this medium to pursue justice and serve the church.

PICKING UP A PLUNGER

A Glimpse into the Overflow of a Young Woman's Heart

9:45 a.m., BSB 112

Kayci Ross (Houston, Texas) 82402-04

Jesus said "For out of the overflow of the heart the mouth speaks." Is there a connection between what we say and what resides in our hearts? What does God expect us to do with it and how can our "overflow" be pleasing to Him? This class discusses the challenges we face surrendering all we are to the Lordship of Jesus.

GOSPEL GRAFFITI

Reflections on Defacing the Art of God

9:45 a.m., BSB 113

Kevin J. Youngblood (Henderson, Tenn.) 82402-05

God's truth is more than just right; it also is beautiful. Therefore, when God's truth is suppressed there is a corresponding loss of beauty both in ourselves and in our world. Paul encourages us to consider the aesthetic implications of sin in Romans 1:18-23 so that we will understand that not only is sin illogical, it also is unappealing. It is an anti-aesthetic that robs our lives and world of divine beauty.

CONFESS AND BELIEVE JESUS CHRIST IS THE LORD (ROMANS 10:9)

Persecution and Revival in China

9:45 a.m., BSB 114

Bob Fu (Midland, Texas) 82402-06

Part 2 of 3.

GROWING OLD IN CHRIST: BLESSINGS AND CHALLENGES OF MINISTRY TO THE AGING

Aging with Grace: Growing Old for the Next Generation

9:45 a.m., BSB 115

Jack Holland (Johnson City, Tenn.) 82402-07

Part 3 of 3.

BSB – Onstead-Packer Biblical Studies Building MBB – Mabee Business Building WPA – Williams Performing Arts Center

Exhibits

- Visit booths in Teague Special Events Center sponsored by a variety of vendors, or purchase Lectureship CDs and DVDs
- For more information or to register online www.acu.edu/lectureship

KINGDOM LIFE REMIXED
The Conversation Continues ...

9:45 a.m., BSB 117

Facilitator: Kent Smith (Abilene, Texas)

Panelists: Jared Looney (Bronx, N.Y.),
John White (Denver, Colo.) 82202-10

Part 3 of 3.

WALKING WITH THE SPIRIT:
THE TRANSITIONS OF K.C. MOSER
Dawn: Moser's Spiritual Legacy

9:45 a.m., BSB 120

Bobby Valentine (Tucson, Ariz.) 82402-09

Part 3 of 3.

FUNDRAISING FOR SAM'S PLACE

9:45 a.m., BSB 122

Vernon Williams (Abilene, Texas) 82402-10

Sam's Place is an orphanage for the deaf in East Kenya initiated by the late Sam McReynolds, ACU professor emeritus of mathematics. This class discusses fund-raising techniques and timelines for soliciting funds for the completion of this orphanage.

OLIVE TREES AND CYBORGS
Our Christian Identities Here and Now

9:45 a.m., BSB 127

Jennifer J. Thweatt-Bates (New York, N.Y.) 82402-11

TENACIOUS HOSPITALITY:
WELCOMING THE UNWELCOMED
Those Children Just Don't Fit In! Include Them Anyway

9:45 a.m., BSB 128

MaLesa Breeding (Abilene, Texas),
Dana Hood (Abilene, Texas) 82402-12

Part 2 of 2.

HOW TO WIN THE WAR AGAINST DRUG ABUSE ...
In Your Community

9:45 a.m., BSB 129

Kinwood H. DeVore (San Francisco, Calif.) 82402-13

Part 3 of 3.

PULLING TOGETHER WITHOUT COMING APART:
A PANEL ON ELDER-MINISTER RELATIONSHIPS
Praying Together

9:45 a.m., BSB 130

Dean Bryce (Stillwater, Okla.), Malcolm Coco
(Abilene, Texas), Eddie Sharp (Abilene, Texas),
Jay Spencer (Paris, Texas) 82402-14

Part 3 of 3.

DEMOLITION

9:45 a.m., BSB 200 (Chapel on the Hill)

Sam Solomon 82402-15

"BUT I WAS JUST PREACHING!" PROCLAIMING
JUSTICE AND HOPE FROM THE OLD TESTAMENT
After Accusation and Guilt: Preaching the
Prophets in the Contemporary Church

9:45 a.m., BSB 100 (Hart Auditorium)

Mark Hamilton (Abilene, Texas),
Stephen Johnson (Abilene, Texas),
Tim Sensing (Abilene, Texas) 82402-16

Part 2 of 2.

11 A.M. THEME CONVERSATION

TRANSFORMED BY GOD
Romans 12:1-21

11 a.m., Moody Coliseum

Worship: Come As You Are

Eric L. Wilson (Columbia, Mo.) 82403-01

1:30 P.M. HIGHLIGHT CLASSES

LIFESTYLES OF THE RICH AND AMOS
Why Rich Religion Gets Its Way

1:30 p.m., BSB 100 (Hart Auditorium)

Rick Atchley (Fort Worth, Texas) 82404-01

Part 3 of 3.

RELATIONSHIP 101: EIGHT THINGS
EVERY LOVER NEEDS TO SAY
Christ's Holy Guidance System

1:30 p.m., Teague Special Events Center

Jeff Walling (Charlotte, N.C.) 82404-02

Part 3 of 3.

WEDNESDAY
September 24

The World Famous Bean
(Monday-Friday)

- Breakfast 7-9:30 a.m.
- Lunch: 11:30 a.m. - 2 p.m.
- Dinner 5-7 p.m.

Lunch at The Grill on the Hill

- BSB, Chapel on the Hill Portico
- 11:30 a.m. - 1:15 p.m.

3 P.M. FEATURED GUEST

SENTENCED TO DEATH

3 p.m., Moody Coliseum
Sam Solomon 82405-01

4 P.M. CLASS OPTIONS

NEW HYMNS, OLD PROBLEMS

Mess with My Hymns? Don't Even Think About It!

4 p.m., BSB 103
Jack Boyd (Abilene, Texas) 82406-01
 Part 2 of 2.

WOULD THE APOSTLE PAUL USE THE INTERNET?

MISSIONS IN A WIRED WORLD

Be Plugged into All Your Missions Efforts Through Creative Internet Use

4 p.m., BSB 104
Steve Austin (Abilene, Texas) 82406-02
 Part 2 of 2.

THE GOD-PRAISING AND EARTH-CARING COMMUNITY

Making a Change That Makes a Difference

4 p.m., BSB 112
Eric Yates (Little Rock, Ark.) 82406-03
 Part 2 of 2.

CHRISTIAN DIGITAL ENTERTAINMENT

The Call for Leadership

4 p.m., BSB 113
Brian G. Burton (Abilene, Texas) 82406-04

The last 20 years have seen an explosion in digital entertainment on the computer and TV, yet we as Christians have failed to keep pace. This session examines one effort to provide and train the next generation of leaders in the field of digital entertainment. Current ACU students involved in the project contribute to the conversation.

CONFESS AND BELIEVE JESUS CHRIST IS THE LORD (ROMANS 10:9)

Persecution and Mission in China

4 p.m., BSB 114
Bob Fu (Midland, Texas) 82406-05
 Part 3 of 3.

SEX, LIES AND RELATIONSHIPS

4 p.m., BSB 115
Anna Peters (Houston, Texas) 82406-06

The media is saturated with sexuality, yet the church is silent about sexuality. There is no more enticing and controversial topic. Youth today have questions about how to handle the issues of dating, relationships and sex – and few know to look to God in the Bible for answers and perspective. Explore a biblical, honest and healthy discussion of sexuality led by an ACU student.

REDEFINING CHRISTIANISM

Disturbing the Comfortable

4 p.m., BSB 117
*Matt Wallace (Denver, Colo.),
 Nikki Wallace (Denver, Colo.)* 82406-07
 Part 2 of 2.

WOMEN'S VIOLENCE IN GLOBAL POLITICS

Why Christians Should Care About Depictions of Women

4 p.m., BSB 120
Caron E. Gentry (Abilene, Texas) 82406-08
 Part 2 of 2.

MULTICULTURALISM AND DIVERSITY: THE 21ST CENTURY CHALLENGES FOR THE CHURCH

We Want to Diversify, We Just Don't Know How

4 p.m., BSB 127
George Pendergrass (Abilene, Texas) 82406-09
 Part 2 of 2.

BSB – Orstead-Packer Biblical Studies Building MBB – Mabree Business Building WPA – Williams Performing Arts Center

Food Kiosks

- Teague Special Events Center
- Available throughout the day

iTunes U

- Selected classes and theme conversations will be available after the event by visiting ACU on iTunes U to download MP3 files
- www.acu.edu/itunesummit

WHEN PEACE BREAKS OUT

A Righteous God Reveals the Recipe for Peace

4 p.m., BSB 128

Joey Cope (Abilene, Texas) 82406-10

Part 3 of 3.

EMERGING ELDERS

Shepherding People in a Post-Christian Culture

4 p.m., BSB 129

Ron Clark (Portland, Ore.) 82406-11

Part 3 of 3.

NEWFOUND AWARENESS

An Actual Step Forward

4 p.m., BSB 130

Damon Parker (Abilene, Texas),
Beatriz Alem Walker (Abilene, Texas) 82406-12

One of the struggles in dealing with issues of race in our churches is we are often left feeling there is nothing we can do. We become hopeless and, not surprisingly, nothing changes. So how can awareness of racial issues become a positive first step toward true racial reconciliation? What can we actually do to begin the process in our own lives and churches?

CONQUEST: FINDING YOUR PLACE IN GOD'S MISSION

Attacking the Big Enemy First

4 p.m., BSB 200 (Chapel on the Hill)

Scott Sager (Dallas, Texas) 82406-13

Part 3 of 3.

7 P.M. THEME CONVERSATION

WELCOME OTHERS AS CHRIST

Romans 15:1-7

7 p.m., Moody Coliseum

Worship Leader: Steven Moore (Abilene, Texas)

Chris Seidman (Dallas, Texas) 82407-01

WEDNESDAY
September 24



CDs and DVDs

- During Lectureship, CDs and DVDs are available in Teague Special Events Center
- To order CDs after Lectureship from rePlay, call 325-674-3744 or order online at www.acureplay.org
- DVDs of theme lectures and featured guest presentations are available from IN-Focus Digital at www.infocusdv.com or 325-672-0715

Program Participants



Steve Allison
Abilene, Texas
14, 16, 23



Rick Atchley
Fort Worth, Texas
8, 20, 26, 31



Steve Austin
Abilene, Texas
14, 27, 32



Joe D. Bell
Abilene, Texas
16



B. Cole Bennett
Abilene, Texas
18, 25



Jim R. Bevis
Florence, Ala.
10, 17, 24, 29



Jack Boyd
Abilene, Texas
27, 32



MaLesia Breeding
Abilene, Texas
10, 26, 31



Tanya Brice
Abilene, Texas
11, 17, 23, 29



Geoffrey Broderick
Abilene, Texas
12, 19, 22



Doug Brown
San Antonio, Texas
10, 29



Dean Bryce
Stillwater, Okla.
10, 20, 26, 31



D.J. Bulls
Arlington, Texas
28



Brian G. Burton
Abilene, Texas
32



Steven Carrizal
Denton, Texas
23



Ron Clark
Portland, Ore.
10, 22, 28, 33



Malcolm Coco
Abilene, Texas
10, 20, 26, 31



Dan Cooke
Denton, Texas
22



Joey Cope
Abilene, Texas
10, 22, 28, 32



Kinwood H. DeVore
San Francisco, Calif.
9, 14, 20, 26, 31



Kyle Dickson
Abilene, Texas
14, 15



Ian Fair
Durango, Colo.
10, 17, 24, 30



Douglas A. Foster
Abilene, Texas
8, 10, 11, 22, 28



Robert L. Foster
Dallas, Texas
21, 27



David W. Frazee
Fort Worth, Texas
14, 16



Bob Fu
Midland, Texas
8, 11, 29, 30, 32



Edward Fudge
Houston, Texas
11, 23, 29



Jorge Daniel Garcia
Abilene, Texas
16, 29



Sally Gary
Abilene, Texas
18, 25, 30



Caron E. Gentry
Abilene, Texas
21, 32

Program Participants



Jessica Reese Goudeau
Austin, Texas
10, 20



Sonny Child
Abilene, Texas
21, 27



Mark Hamilton
Abilene, Texas
18, 24, 26, 30, 31



Joyce Hardin
Dripping Springs, Texas
18



Houston Heflin
Richardson, Texas
14, 19



Larry Henderson
Abilene, Texas
24, 30



Patricia Hernandez
Abilene, Texas
16, 29



Ron Highfield
Agoura Hills, Calif.
21



Jack Holland
Johnson City, Tenn.
19, 25, 30



Jeff Holland
Denison, Texas
16, 23



Becky Holton
York, Neb.
21, 27



Dana Hood
Abilene, Texas
10, 26, 31



Stephen Johnson
Abilene, Texas
14, 26, 31



Kenny Jones
Abilene, Texas
12, 24



Darrell Jordan
Abilene, Texas
11, 17, 23, 29



Greg Kendall-Ball
Abilene, Texas
11, 30



Jacqueline King
Denton, Texas
11, 16



Linda A. King
Edmond, Okla.
10, 23, 29



Jared Looney
Bronx, N.Y.
14, 19, 25, 31



Hollis Maynard
Lubbock, Texas
19



Casey McCollum
Richardson, Texas
14, 23



Taylor A. McKenzie
San Diego, Calif.
10, 21, 27



Lynn A. McMillon
Oklahoma City, Okla.
23



Steven T. Moore
Abilene, Texas
33



Ginger Morby
Surprise, Ariz.
12, 18, 26



Larry Mudd
New York, N.Y.
14, 22, 29



Lee Ann Nutt
Denton, Texas
10, 19, 25



Robert Oglesby Jr.
Abilene, Texas
14, 21, 24



Thomas H. Olbricht
South Berwick, Maine
17, 24, 30



Damon Parker
Abilene, Texas
8, 11, 33

Program Participants



Glenn Pemberton
Abilene, Texas
9, 17, 24



George Pendergrass
Abilene, Texas
10, 15, 28, 32



Anna Peters
Houston, Texas
9, 32



Ryan Porche
Dallas, Texas
22



Larry Prince
Abilene, Texas
25



Robert M. Randolph
Cambridge, Mass.
25, 27



Bert Reynolds
Little Rock, Ark.
17, 24, 29



Charme Roberts
Dallas, Texas
11, 18



Edward J. Robinson
Abilene, Texas
10, 22



Floyd Rose
Valdosta, Ga.
18, 25



Beverly Ross
Decatur, Texas
19



Kayci Ross
Houston, Texas
30



Scott Sager
Dallas, Texas
22, 28, 33



Shelly Sanders
Abilene, Texas
14, 28



Steve Sargent
Houston, Texas
14, 23



Dorris M. Schulz
N. Richland Hills, Texas
25



Tim Sensing
Abilene, Texas
26, 31



Eddie Sharp
Abilene, Texas
10, 20, 26, 31



Rubel Shelly
Rochester Hills, Mich.
20, 26



Jennifer Shewmaker
Abilene, Texas
16, 23



Tracy M. Shilcutt
Abilene, Texas
18, 25



Brandon James Smith
Overland Park, Kan.
9, 11, 21



Kent Smith
Abilene, Texas
14, 19, 25, 31



Jay Spencer
Paris, Texas
10, 20, 26, 31



Travis Stanley
Irving, Texas
8, 11, 28



Scott K. Stegall
Denton, Texas
10, 25



Shirley D. Straker
Ontario, Canada
17, 24



Stephanie Talley
Abilene, Texas
16, 23



Walter L. Taylor
Lewisville, Texas
8, 11, 28



Rob Thomas
Dallas, Texas
12, 21

Program Participants



Jennifer J. Thweatt-Bates
New York, N.Y.
19, 25, 31



Bobby Valentine
Tucson, Ariz.
10, 19, 25, 31



Kelly Vaughn
Fort Worth, Texas
17, 24, 29



Beatriz Alem Walker
Abilene, Texas
8, 11, 33



Matt Wallace
Denver, Colo.
14, 28, 32



Nikki Wallace
Denver, Colo.
14, 28, 32



Jeff Walling
Charlotte, N.C.
9, 20, 26, 31



Margaret J. Weber
Malibu, Calif.
10, 16, 23



John White
Denver, Colo.
14, 17, 19, 24, 25, 29, 31



Chris Willerton
Abilene, Texas
9, 16, 23



Vernon Williams
Abilene, Texas
31



**Matthew Ryan
Worthington**
San Antonio, Texas
9, 11, 27



Eric Yates
Little Rock, Ark.
14, 27, 32



Kevin J. Youngblood
Henderson, Tenn.
12, 30

2008 Exhibitors

Visit these and other exhibitors in the Teague Special Events Center
Sunday 6-10 p.m. • Monday-Wednesday 8 a.m. - 10 p.m.

ACU Graduate School of Theology
Albuquerque Christian
Children's Home
Aurora Kids Art Expressions
Bible Barn
Cassandra's Gift Shop
Cecil Hook Publishing Ministry
CenterPeace
China Now
Christian Homes of Abilene
Christ's Haven for Children
Dallas Christian Sound and Books
Eternal Threads
Foster's Home for Children
Global Christian University

Halbert Institute for Missions
Health Talents International
IHCF / African Christian Hospitals
Let's Start Talking Ministry
Manuelito Christian Children's Home
Members of Churches of Christ
for Scouting
Mission Alive
Mission South Pacific
Missions Resource Network
Monk's Coffee Shop
New Mexico Christian
Children's Home
Olan Mills
Pastors Retreat Network

Pruett Gerontology Center
Rapha International
Sanctuary Home for Children
Sauder Worship Furniture
Shepherd's Staff
Texas Gulf Coast Bible Institute
The ACU Foundation
Timothy Hill Children's Ranch
Tipton Home
Trimble Studios
Westview Boys' Home
World Christian Broadcasting
World English Institute
... and more

Meals and Meetings

Sunday, September 21

4:45 p.m.

Asia Interest Group Dinner
BSB 219 (Mission Strategy Room)
Speakers: Ben Berry and
Jonathan Straker
Tickets: \$5 at the door
Contact: Chris Flanders, 325-674-3742
or clf03c@acu.edu

8:45 p.m.

**World Christian
Broadcasting Reception**
*McGlothlin Campus Center,
Living Room*
Speaker: Charles Caudill,
WCB President
Contact: Earline Perry, 325-677-8866
or earlineperry@msn.com

Monday, September 22

6:45 a.m.

**Haitian Christian Foundation
Breakfast**
*University Church of Christ,
Family Room (733 E.N. 16th St.)*
Speakers: David Dirrim, Director of
the Center for Biblical Training
in Haiti, and Dr. John Estes Jr.,
Secretary of HCF
Tickets: Complimentary
Contact: Ann Herron, 325-677-0033
or hcfcbt@juno.com

Missions Prayer Breakfast
**Sponsored by Missions
Resource Network**
*McGlothlin Campus Center,
Living Room*
Tickets: Complimentary
Contact: Marti Wise, 817-267-2727
or missions@mrnet.org

Noon

Ag Missions Luncheon
**Co-hosted by Global
Samaritan Resources**
*Hillcrest Church of Christ, Family
Room (650 E. Ambler Ave.)*
Tickets: Complimentary
Please RSVP to Mandy Scudder
Contact: Mandy Scudder,
325-674-2401 or scudder@acu.edu

**Friends of the
International University**
*McGlothlin Campus Center,
Living Room*
Tickets: Complimentary
Contact: Noble Harris, 325-676-3605

Let's Start Talking Ministry
*McGlothlin Campus Center,
East Dining Room*
Speaker: Darin Campbell
Tickets: \$10
Contact: LST, 817-684-7578
or LST@LST.org

3:30-4:30 p.m.

Friends of the ACU Library Buffet
Brown Library, Learning Commons
Honoring: Friends of the Year,
the Horace Coffman family
Speaker: Leonard Allen, Director of
ACU Press / Leafwood Publishers
Contact: Elaine Huckabee,
325-674-2344 or
elaine.huckabee@acu.edu

5 p.m.

**African Missions
Fellowship Dinner**
*University Church of Christ,
Family Room (733 E.N. 16th St.)*
Speaker: John Reese
Tickets: \$5 at the door
Contact: Dr. Sonny Guild,
325-674-3710 or
guild@bible.acu.edu

**Christian Child and Family
Services Association Dinner**
Briarstone Manor (101 Eplen Court)
Speaker: Darrell Jordan, LCSW, DCSW,
ACU Assistant Professor
of Clinical Social Work
Tickets: \$12.50
Contact: Sherri Statler or Terri Engel,
325-677-2205 or
atn@christianhomes.com

Continent of Great Cities Dinner
*University Church of Christ, Ministry
Activity Center (733 E.N. 16th St.)*
Tickets: Complimentary
Contact: Kay Shelton, 214-466-6200
or kay@greatcities.org

Mission Alive Dinner
WPA, Lobby
Speaker: Randy Harris
Honorees: Tony and Laura Chron
Tickets: \$10 at the door
Contact: Gailyn Van Rheenen,
972-939-4337 or
gailyn@missionalive.org

**Sunset International
Bible Institute Dinner**
*McGlothlin Campus Center,
Living Room*
Tickets: Brown Bag
(drinks will be provided)
Contact: Bob Jackson, 806-788-3259
or bosanjack@aol.com

8:30 p.m.

**York College
Friends and Alumni Reception**
*McGlothlin Campus Center,
Living Room*
Contact: Brent Magner, 402-363-5636
or brent.magner@york.edu

Tuesday, September 23

7 a.m.

Herald of Truth Ministries

*McGlothlin Campus Center,
Living Room*

Speaker: Steve Ridgell

Tickets: Complimentary

Contact: Karen Presley, 325-698-4370
or kpresley@heraldoftruth.org

Restoration Quarterly Breakfast

*University Church of Christ,
Family Room (733 E.N. 16th St.)*

Contact: James Thompson,
325-674-3781 or
Thompson@bible.acu.edu

World Bible School Breakfast

WPA, Lobby

Speaker: John Reese

Tickets: Complimentary,
pick up at booth

Contact: Mickie Kennedy,
512-345-8190 or
mickie@worldbibleschool.net

Noon

Canada: Mission Opportunities

Sponsored by Great Lakes
Christian College and
Western Christian College

*McGlothlin Campus Center,
Living Room*

Speaker: Don Rose, President of GLCC,
and Kevin Vance, President of WCC

Tickets: Complimentary

Contact: Bob Gomez, 325-672-5114
or cutabob@aol.com

Halbert Institute for Missions Luncheon

WPA, Lobby

Honoree: Karen Alexander

Tickets: \$12

Contact: Halbert Institute for Missions,
325-674-3711 or missions@acu.edu

"Seeing the Bible through the Eyes of the Artist"

Artist Brown Bag Sponsored by
ACU Art and Design Department

*Don H. Morris Center,
Shore Art Gallery*

Speaker: Garlan Jenkins

Contact: Garlan Jenkins,
gfj07a@acu.edu

4:45 p.m.

Men's Fellowship Dinner

*University Church of Christ, Ministry
Activity Center (733 E.N. 16th St.)*

Speaker: Lynn McMillon

Tickets: \$7 purchase at registration
in Teague Special Events Center
or at the door

Contact: Ministry Events,
325-674-3750 or min-
istryevents@acu.edu

Women for ACU Dinner

WPA, Lobby

Speaker: Linda Egle

Tickets: \$12

Contact: Samantha Adkins,
325-674-2622 or wacu@acu.edu

6-6:45 p.m.

"The Bible and the Artists of the 20th Century"

Gallery Talk and Tour

Sponsored by ACU

Art and Design Department

*Don H. Morris Center,
Shore Art Gallery*

Speaker: Garlan Jenkins

Contact: Garlan Jenkins,
gfj07a@acu.edu

8:30 p.m.

Rochester College

Friends and Alumni Reception

*McGlothlin Campus Center,
Living Room*

Contact: Kyle Martin, 248-218-2059
or development@rc.edu

Wednesday, September 24

Noon

Graduate School of Theology Alumni Luncheon

WPA, Lobby

Speaker: Jennifer Nicholson

Tickets: Complimentary, pick up
from College of Biblical Studies,
Dean's Office

Contact: Sandy Lowe, 325-674-3700
or lowe@bible.acu.edu

Registration • *How much does Summit cost?*

Summit is an event open to all who register. You are required to register and wear a name tag for entry into event activities. There is no registration fee. Online pre-registration is available at www.acu.edu/lectureship. During the event, please register and pick up registration packet at the Teague Special Events Center or the Onstead-Packer Biblical Studies Building.

Child Care • *What can I do with my children?*

Excellent childcare is provided for pre-school children at no charge for those who register. Please pre-register your child to ensure availability:

Daytime care (Hillcrest Church of Christ Nursery)
8 a.m. - 12:15 p.m. and 1:30-5 p.m.
6 months to 5 years of age only

Evening care (Gibson Health and P.E. Center, Room 234) 6:30-9 p.m.
2 to 5 years of age only

Exhibits • *Where can I go for conversation, pies, coffee and information?*

More than 100 exhibits are located in the Teague Special Events Center, a central place for conversation and fellowship. For more information about exhibits or to reserve exhibit space, contact Sandy Lowe at 325-674-3701 or lowe@bible.acu.edu.

Meals • *Where can I eat on campus?*

The World Famous Bean
Breakfast 7-9:30 a.m.
Lunch 11:30 a.m. - 2 p.m.
Dinner 5-7 p.m.

The Grill on the Hill
(BSB, Chapel on the Hill Portico)
Lunch 11:30 a.m. - 1:15 p.m.

Please see pages 38-39 for the full meal and reception schedule.

Shuttle Service • *How can I get around campus?*

Shuttle Service will be provided throughout Summit / Lectureship at no charge from 7 a.m. - 10 p.m. Pick up/drop off locations include Hillcrest Church of Christ, University Church of Christ, Onstead-Packer Biblical Studies Building, Williams Performing Arts Center, and

Moody Coliseum. During the event, call 325-674-3744 to arrange transportation.

Recordings • *How can I listen to classes I miss or classes I enjoyed and wish to hear again?*

During Summit / Lectureship, CDs and DVDs are available in Teague Special Events Center.

CDs: The sale of CDs sold during Summit will benefit Ghana Ministries. These proceeds benefit Ghana ministries to children and the Heritage Christian School. After the event, CDs may be ordered from rePlay at www.acureplay.org or by calling 325-674-3744.

DVDs: Provided by IN-Focus Digital at www.infocusdv.com or 325-672-0715.

iTunesU: Selected classes and theme conversations will be available after the event by visiting ACU on iTunes U, where you can download MP3 files. www.acu.edu/itunesummit

Upcoming Events • *What other events are coming soon?*

Summit 2009
September 20-23

ElderLink Forum

A ministry offered by Abilene Christian University, Elderlink Forum is designed to equip, encourage and link those who lead and serve as elders in Churches of Christ. For details and registration information go to www.acu.edu/ministry/elderlink

Portland, Oregon • October 3-4, 2008
Dallas, Texas • November 8, 2008
Rancho Cordova, Calif. • February 6-7, 2009

Center for Conflict Resolution

A full-featured program of the university, the ACU Center for Conflict Resolution offers training and services in both conflict prevention and intervention for churches, organizations, and individuals. For more information: 325-674-2015, conflictresolution@acu.edu, www.acu.edu/conflict



The interior pages of this booklet were printed on recycled paper.

With Special Thanks

Many people help make Summit a reality. First, we thank you – one of thousands of Summit participants who make time to visit our campus! In addition to theme speakers, featured guest presenters, class presenters, exhibitors, ARAMARK food services, and many ACU offices and departments, we have special thanks for:

- Holly Harrell and Sarah Bales – brochure graphic designers
- ACU Student Planning Team (Crystal Chavez, Kenneth Dinkins, Brian Escochea, Jeremiah Gibson, Tony Godfrey, Joshua Jackson, Bradon Lewis, Byron Martin, Anna Peters, Mary Rix, Brandon Smith, Brit'ny Spain, Haley Sutherland, Matt Worthington)
- College of Biblical Studies Faculty Advisory Team
- Jerry Drennan – organized the deaf interpreters
- Jeremiah Gibson and Come as You Are – worship
- Vicki Britten and Development Operations staff – registration
- George Saltsman and Steve Knight – technology in Moody Coliseum
- Sandy Lowe and Stephanie Lang – exhibits
- Gary Varner – special stage setup
- ACU Physical Resources Team
- University Events Team
- Hillcrest Church of Christ – use of their nursery facilities
- Ron Hadfield, Amber Gilbert and the staff of ACU Creative Services
- Lyndell Lee and rePlay – for audio recording
- Kate Miller – four years of service as ministry events coordinator

Ministry Events Registration

Contact Information

FIRST NAME	MIDDLE	LAST
TITLE		ORGANIZATION
MAILING ADDRESS (CHECK CIRCLE FOR: <input type="radio"/> BUSINESS <input type="radio"/> HOME)		
CITY	STATE	ZIP
EMAIL	HOME PHONE	MOBILE PHONE
EMERGENCY CONTACT IN ABILENE DURING EVENT		CONTACT PHONE

Are you:

Interested in *eConnections*, a quarterly email newsletter from the College of Biblical Studies? YES NO

Interested in receiving *ACU Today* magazine? YES NO

- | | | | |
|---|---------------------------------------|---|--|
| <input type="radio"/> High school student:
Graduation year _____ | <input type="radio"/> Ministry leader | <input type="radio"/> Preacher | <input type="radio"/> Campus minister |
| <input type="radio"/> College student | <input type="radio"/> Elder | <input type="radio"/> Youth minister | <input type="radio"/> Worship minister |
| <input type="radio"/> Graduate student | <input type="radio"/> Deacon | <input type="radio"/> Education minister | |
| | <input type="radio"/> Bible teacher | <input type="radio"/> Children's minister | |

Pre-Registration for Activities and Services

- Childcare for preschool age children
- Musica Romana: Fifteen Centuries of Roman Music, Tuesday, 8:30 p.m.
- Graduate School of Theology Lunch, Wednesday, noon
- RV parking:
 - Sunday Monday Tuesday Wednesday

Three Ways to Register

Online: www.acu.edu/lectureship

Fax: 325-674-6783

Mail: ACU Box 29423

Abilene, Texas 79699-9423

Faculty, Staff and Student Parking

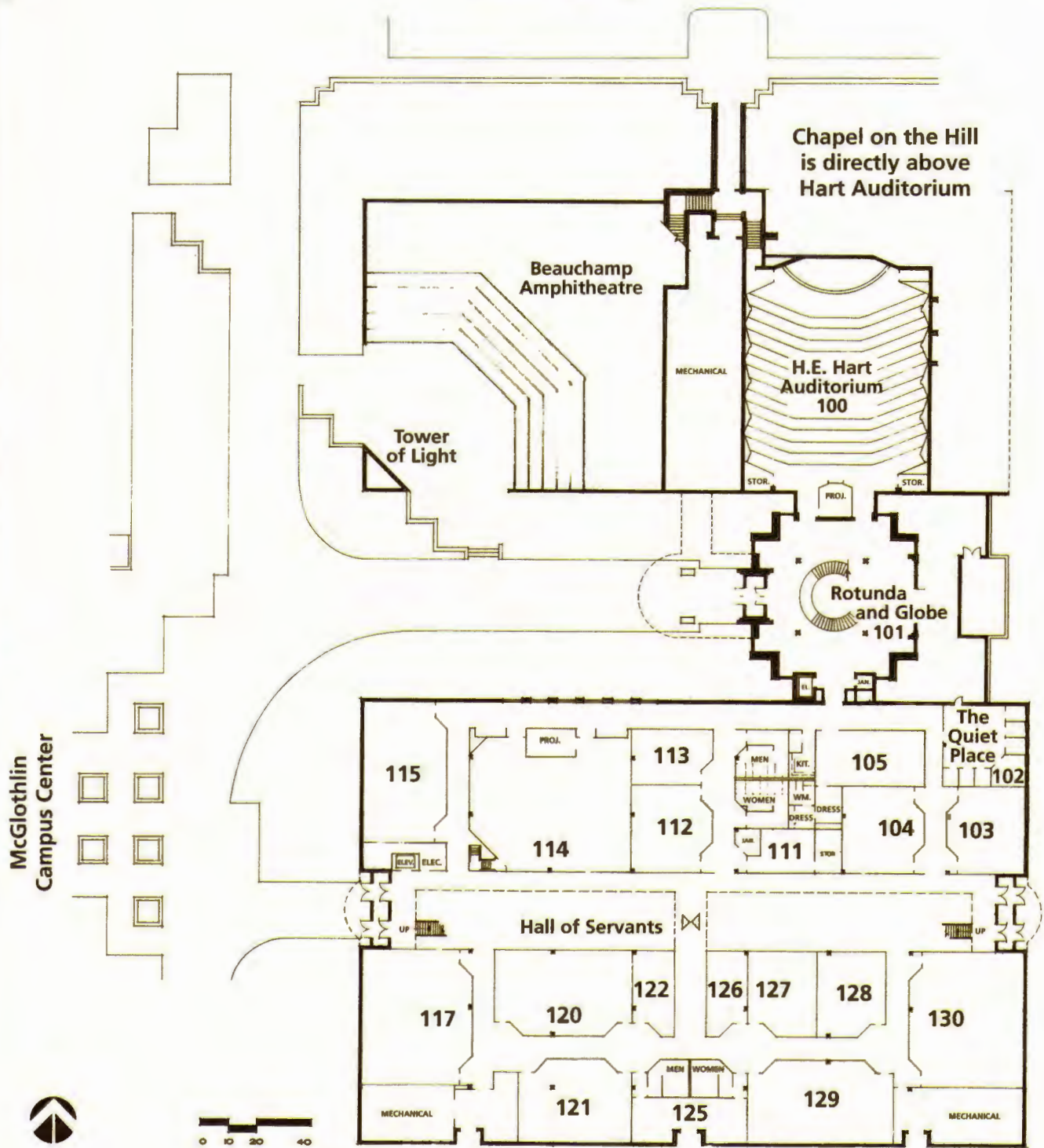

First Floor
Biblical Studies Building

For iPhones, smart phones, and PDAs with internet access, try our new online mobile map at acu.mobi

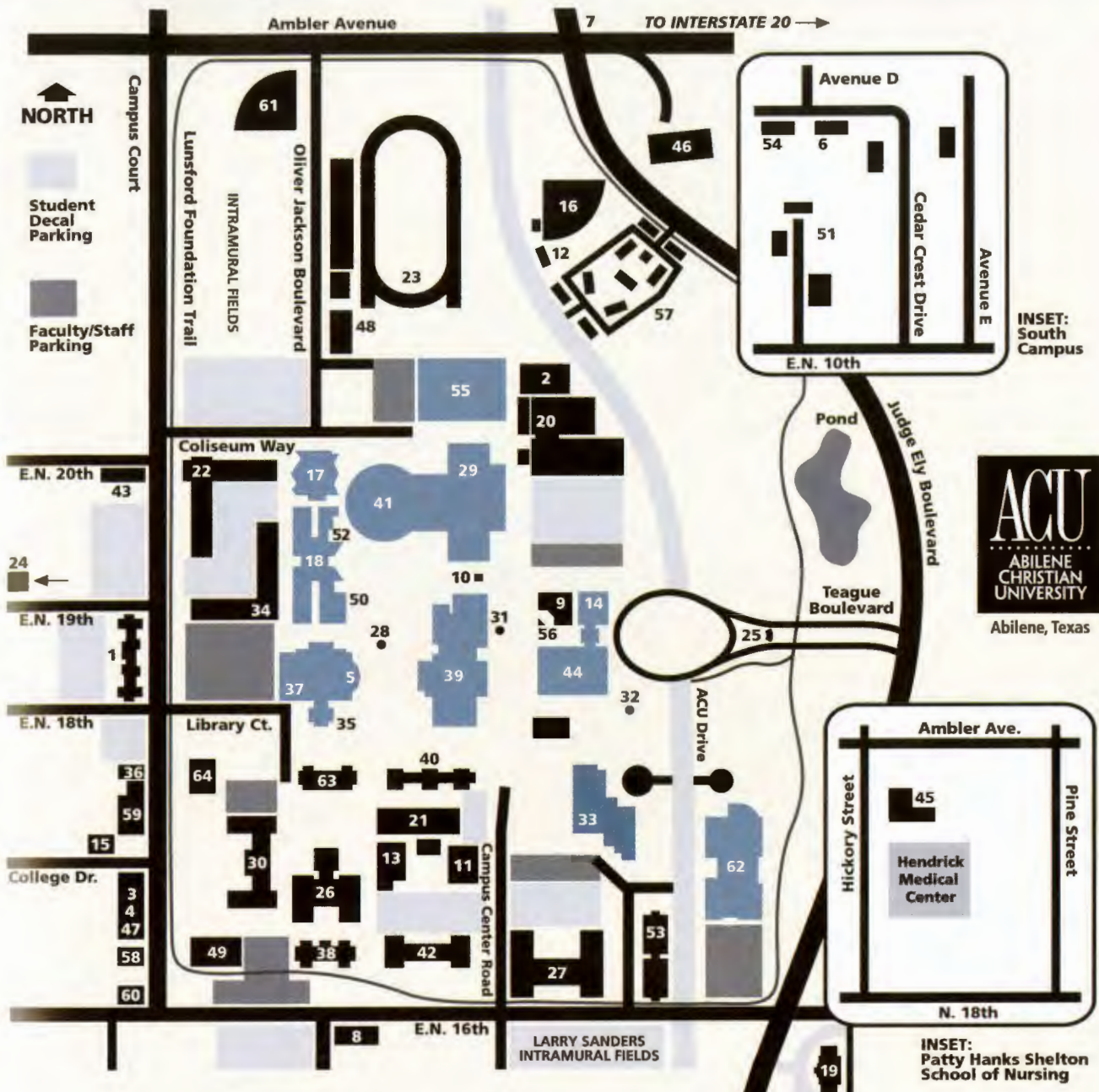

- 1 – A.B. Barret Hall (BRT)
- 2 – A.B. Morris Hall (MOR)
- 3 – Abilene Educational Supply (AES)
- 4 – ACU Press (PRS)
- 5 – **Adams Center for Teaching Excellence (LIB)**
- 6 – Adams Hall (ADH)
- 7 – Allen Farm (FAR)
- 8 – Alumni Relations/Moore House (MRE)
- 9 – Beauchamp Amphitheatre (AMP)
- 10 – Bell Tower (BEL)
- 11 – Bennett Gymnasium (BEN)
- 12 – Bonneau Family Indoor Batting Facility (BON)
- 13 – Chambers Hall (CHA)
- 14 – **Chapel on the Hill (COH)**
- 15 – Computer Service Center (CSC)
- 16 – Crutcher Scott Field (CSF)
- 17 – **Cullen Auditorium (CUL)**
- 18 – Don H. Morris Center (DMC)
- 19 – Duncum Center for Conflict Resolution (CCR)
- 20 – Eager Tennis Pavilion (EAG)
- 21 – Education Building (EDB)
- 22 – Edwards Hall (EDW)
- 23 – Elmer Gray Stadium (EGS)
- 24 – Fire Station Theatre (FST)

- 25 – Flag Plaza (FLG)
- 26 – Foster Science Building (FSB)
- 27 – Gardner Hall (GAR)
- 28 – GATA Fountain (GAT)
- 29 – Gibson Health and Physical Education Center, Scruggs Gymnasium (GIB)
- 30 – Hardin Administration Building (ADM)
- 31 – Hope for the Future Sculpture
- 32 – **Jacob's Dream Sculpture**
- 33 – **Mabee Business Building (MBB)**
- 34 – Mabee Hall (MAB)
- 35 – **Mabee Library Auditorium (MLA)**
- 36 – Mail Production Center (B02)
- 37 – Margaret and Herman Brown Library (LIB)
- 38 – McDonald Hall (MCD)
- 39 – **McGlothlin Campus Center (MCG)**
- 40 – McKinzie Hall (MCK)
- 41 – **Moody Coliseum (COL)**
- 42 – Nelson Hall (NEL)
- 43 – Nichols House
- 44 – **Onstead-Packer Biblical Studies Building (BSB)**
- 45 – Patty Hanks Shelton School of Nursing (PHSH)
- 46 – Physical Resources Building (PRB)

- 47 – Police Department Building (UPD)
- 48 – Powell Fitness Center (PFC)
- 49 – Sewell Theatre (SWL)
- 50 – Sherrrod Building (SHB)
- 51 – Sherrrod Residential Park (SRP)
- 52 – **Shore Art Gallery (SHO)**
- 53 – Sikes Hall (SIK)
- 54 – Smith Hall (SMH)
- 55 – **Teague Special Events Center (TEC)**
- 56 – Tower of Light (TWL)
- 57 – University Park Apartments (UPA)
- 58 – University Studies/North House (NRT)
- 59 – Vanderpool Building (VAN)
- 60 – WACU Museum/Jennings House (WAC)
- 61 – Wells Field (WEL)
- 62 – **Williams Performing Arts Center (WPA)**
- 63 – Zellner Hall and Welcome Center (ZEL)
- 64 – Zona Luce Building (ZON)

2008 SUMMIT

The Righteousness of God: Exploring Romans

The national influence of Abilene Christian University's annual Lectureship began more than 100 years ago.

In January 1907, ACU president Jessie P. Sewell invited preacher Dr. George A. Klingman to lead a week-long lecture series. The popularity of this annual lecture event eventually led to an expanded program in 1918 with a new name – ACU Bible Lecture Program. When it began a century ago, Lectureship was a program for students, who proclaimed it the highlight of the academic year.

As ACU begins its second century, this September the annual Lectureship program dawns the new name "Summit." The longest running annual gathering of Christians and Churches of Christ continues a successful century of following Jesus. Summit is a conversation where life and faith converge in Christ.

ACU provides a space for conversation about real world issues discussed from the perspective of faith. Summit gathers students, church leaders, faculty and Christianity for conversation.

Our aim is that participation in this event will challenge you to see life as ministry and equip you to live as a minister in your everyday life. Together we participate with God in His mission for the world. We hope you leave Summit even more committed to following Jesus. Through this conversation, our prayer is that Christ will be seen more plainly in our neighborhoods, office break rooms, community service and churches.

Submit your registration and make plans now to meet friends Sept. 21-24, 2008. Come join the conversation as we explore Paul's letter to the Romans around the theme "The Righteousness of God."

LECTURESHIP SUMMIT



Abilene Christian University
ACU Box 29423
Abilene, Texas 79699-9423

ADDRESS SERVICE REQUESTED

Nonprofit Org.
U.S. Postage
PAID
Abilene, Texas
Permit No. 626